

USER GROUP: 2-5 Years

RECOMMENDED CREW: 1 Person

TOOLS REQUIRED:

- T-25, TT-45 Torx, 3/4" Hex
- Level, Square
- Auger / Post Hole Digger / Shovel
- Drill Bits: 5/32", 5/8" (Optional)
- High Speed 3/8" Electric Drill with Clutch
- Wood / Plastic Saw (Optional)

NOTE: Use of any other driver may result in damage to tool and/or hardware!

INSTALLATION TIME: 2 Hours

WEIGHT: 117 lbs.

CONCRETE REQUIRED: (8) 80lb. bags - 4.8 ft<sup>3</sup>

NOTE: Concrete must have a minimum rating of 2,500 psi and must be mixed per manufacturer's recommendations.

**PRE-INSTALLATION CHECK:**

Customer is responsible for verifying materials received by comparing received items with packing list. If any parts are missing or damaged, contact your local sales representative immediately.

Supplier is not responsible for items discovered missing after 72 hours from time of delivery.

Before beginning installation, all installers must read and understand the Installation Introduction manual as supplied. If you did not receive a copy, or if you have any questions regarding any information in the Installation Instructions or this Installation Guideline, contact your local sales representative.

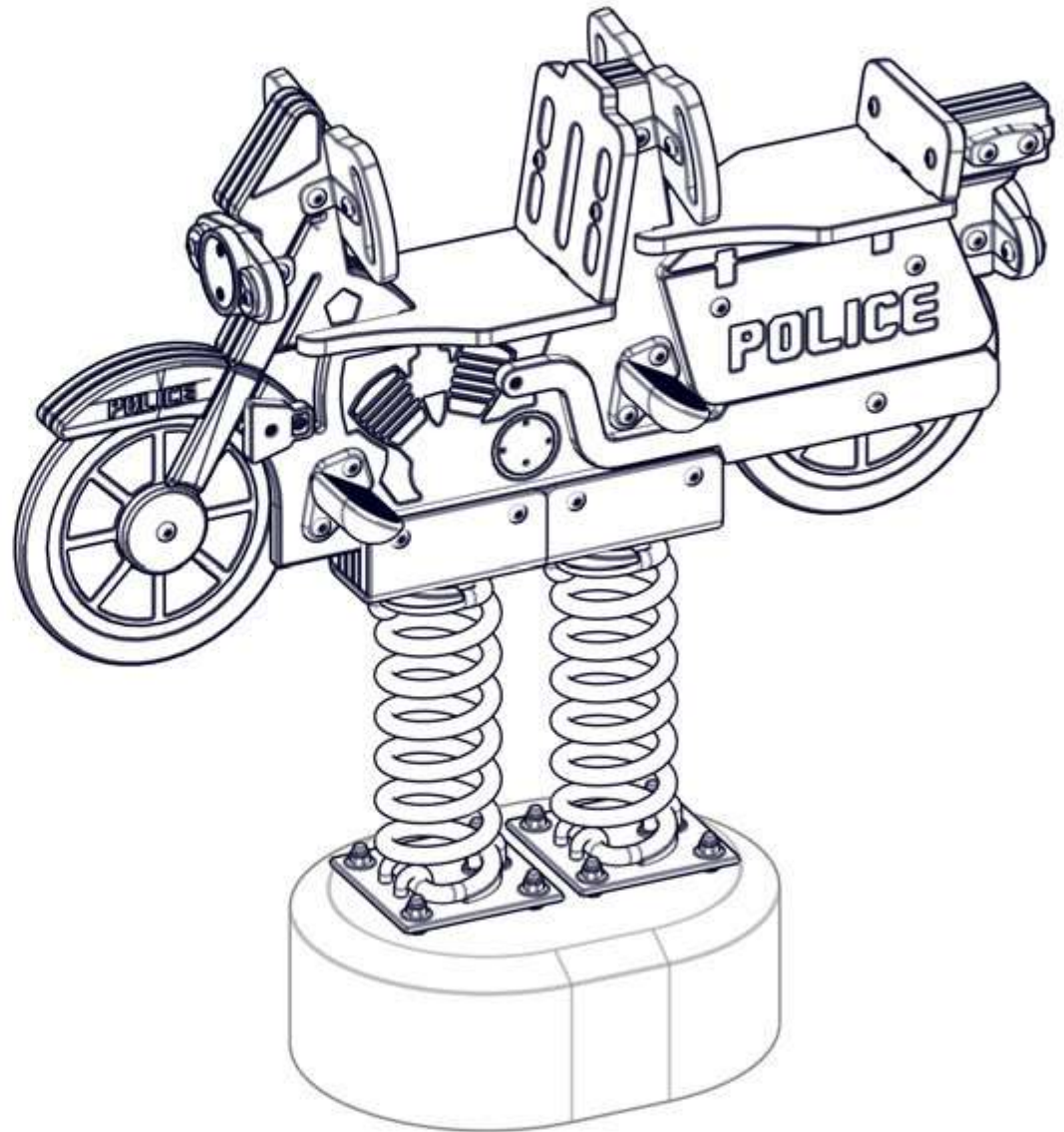



## INSTALLATION GUIDELINE

ITEM	Part No.	QTY	DESCRIPTION
1	RSP-1020-01	1	Sheet - Police Motorcycle Center Body Panel (Black/White/Black)
2	RSP-1022-01	1	Sheet - Police Motorcycle Rider Left Body Panel (Black/White/Black)
3	RSP-1092-01	1	Sheet - Police Motorcycle Exhaust/Spacer Left Hand (Black/White/Black)
4	RSP-1021-01	1	Sheet - Police Motorcycle Right Body Panel (Black/White/Black)
5	RSP-1089-01	1	Sheet - Police Motorcycle Exhaust/Spacer Right Hand (Black/White/Black)
6	RSP-1095-01	2	Sheet - Police Motorcycle Head Light/Tail Light Frame (Black/White/Black)
7	RSP-1096-10	2	Sheet - Police Motorcycle Right Emergency Light (Red)
8	RSP-1098-01	1	Sheet - Police Motorcycle Head Light (Black/White/Black)
9	RSP-1104-15	1	Sheet - Police Motorcycle Tail Light (Yellow)
10	RSP-1101-01	1	Sheet - Police Motorcycle Breather Cover w/ S (Black/White/Black)
11	RSP-1105-01	1	Sheet - Police Motorcycle Front Seat Bottom (Black/White/Black)
12	RSP-1106-01	1	Sheet - Police Motorcycle Rear Seat Bottom (Black/White/Black)
13	RSP-1102-01	2	Sheet - Police Motorcycle Steering Wheel (Black/White/Black)
14	RSP-1100-01	1	Sheet - Police Motorcycle Front Seat Back Rest (Black/White/Black)
15	RSP-1094-01	1	Sheet - Police Motorcycle Rear Seat Back Rest (Black/White/Black)
16	RSP-1091-01	1	Sheet - Police Motorcycle Left Saddlebag (Black/White/Black)
17	RSP-1090-01	1	Sheet - Police Motorcycle Right Saddlebag (Black/White/Black)
18	RSP-1103-15	1	Sheet - Police Motorcycle Marker Light Left (Yellow)
19	RSP-1099-15	1	Sheet - Police Motorcycle Marker Light Right (Yellow)
20	RSP-1093-01	1	Sheet - Police Motorcycle Siren Horn (Black/White/Black)
21	30218101XX	4	Foot Peg - Aluminum W/Two Mounting Holes (COATED)
22	MTA39809XX	2	Coil Spring U-Brkt Asm.
23	HWA0009	8	Anchor 1/2" x 12-1/2" SS J-Bolt
24	HWWR0022	16	Washer 1/2" ID x 1 1/4" Flat Washer 316SS
25	HWN0025	8	Nut 1/2"-13 - Nylock - 316SS
26	HWN0014	8	Nut 1/2-13 Hex - Zinc plated
27	30318103XX	12	L-BRKT 2 3/4" X 1 3/4" X 1-1/2" (Coated)
28	HWB0315	8	Bolt 3/8"-16 x 3/4" TORX Security with Patch
29	HWB0286	4	Bolt 3/8"-16 x 1-1/4" TORX Security with Patch
30	HWB0296	1	Bolt 3/8"-16 x 2" TORX Security with Patch
31	HWB0305	6	Bolt 3/8"-16 x 2-1/4" TORX Security with Patch
32	HWS0097	5	Bolt - 3/8" x 3-1/2" Security Torx With Patch
33	HWB0240	4	Bolt 3/8"-16 x 3" TORX Security with Patch
34	HWB0513	4	Bolt 3/8"- x 4" TORX Security with Patch, 300 Ser. SS
35	HWWR0165	14	Washer 3/8" ID x 7/8" OD General Purpose SS
36	HWN0128	32	Nut 3/8"-16 302 SS TORX Barrel
37	HWS0299	11	Screw 1/4" x 2" RSS SS
38	HWWR0075	4	Washer 3/8" ID x 1" OD Flat - 300 Series SS
39	RSP-1097-02	2	Sheet - Police Motorcycle Left Emergency Light (Blue)
40	HWM0117	1	PL 08 Hand Key - T-45 Security

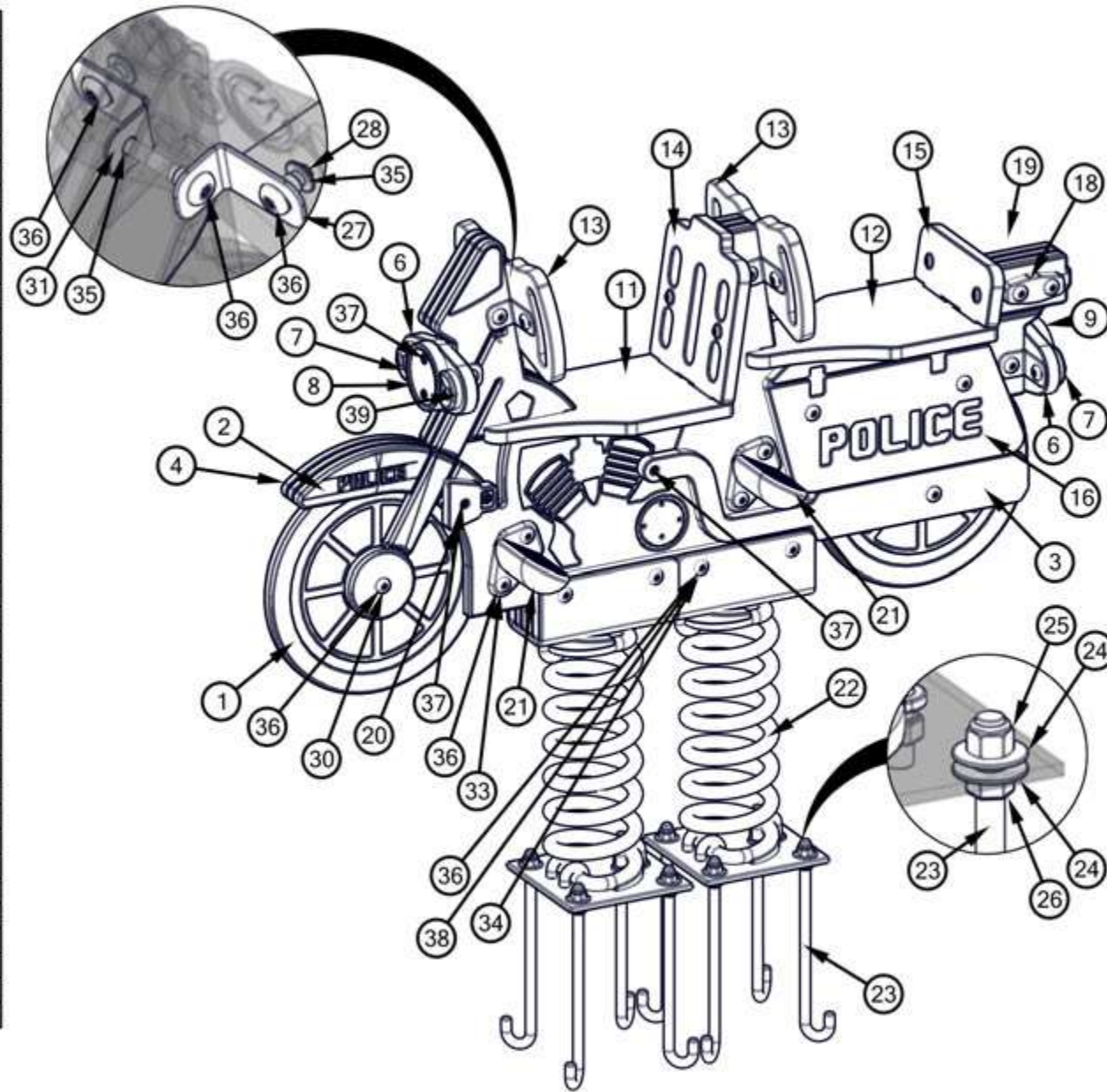

**STEP 1**

Use scrap poly sheet, plywood, etc. (not included) to create anchor bolt template. Cut a rectangle piece of material to a minimum of 25" x 20". Center template on spring base plates. At each hole in spring base plates, drill one (1) 5/8" hole through template.

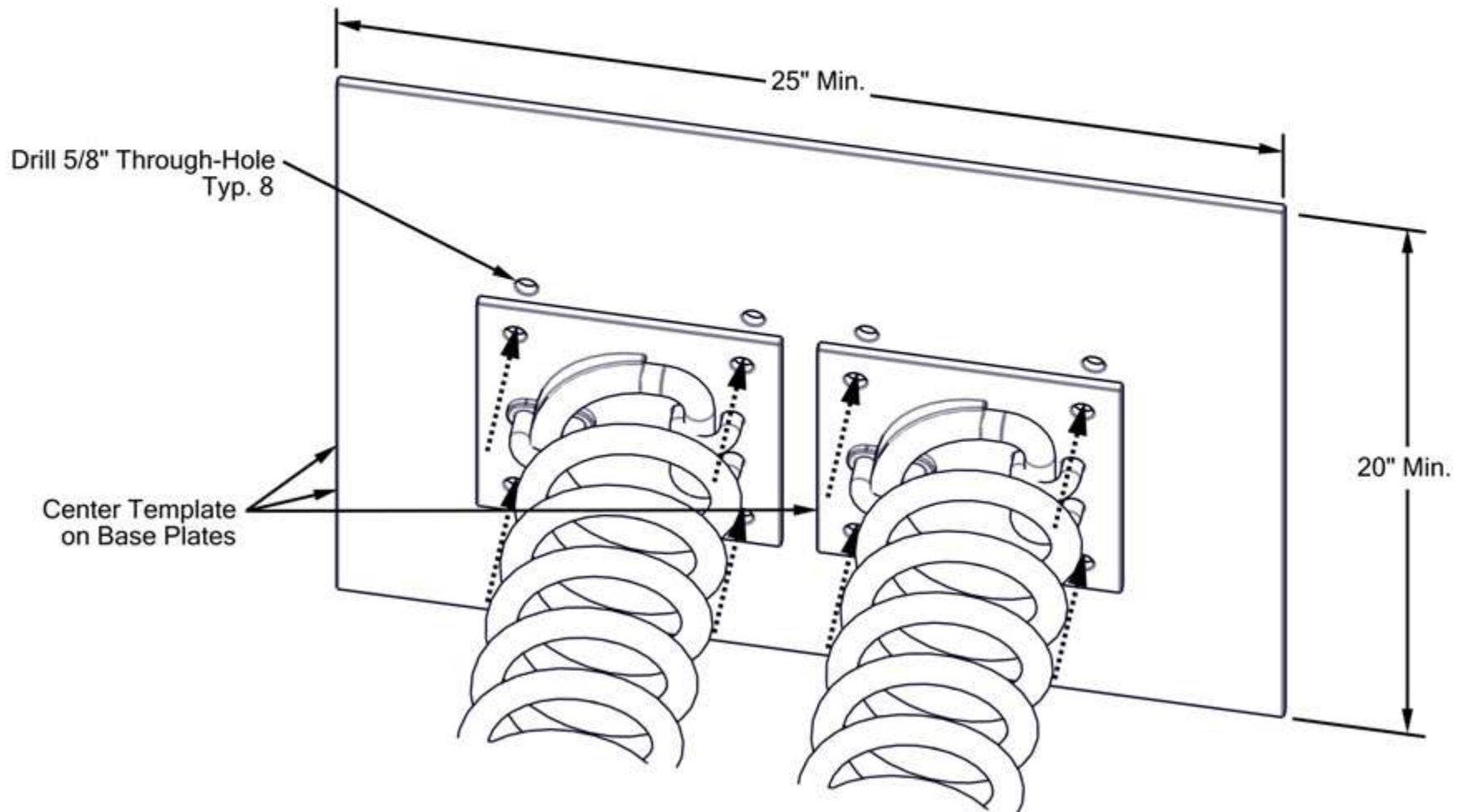



## INSTALLATION GUIDELINE

### STEP 2

Mount J-bolts to template. For each J-bolt, mount one (1) 1/2" hex nut and one (1) 1/2" flat washer. Ensure all nuts and washers are same distance from bottom of nut to end of J-bolt. See Detail 2-1. Place each J-bolt through holes in template. Hook of J-bolts should point to corners of template. Secure each J-bolt with one (1) 1/2" flat washer and one (1) 1/2" Nylon lock nut.

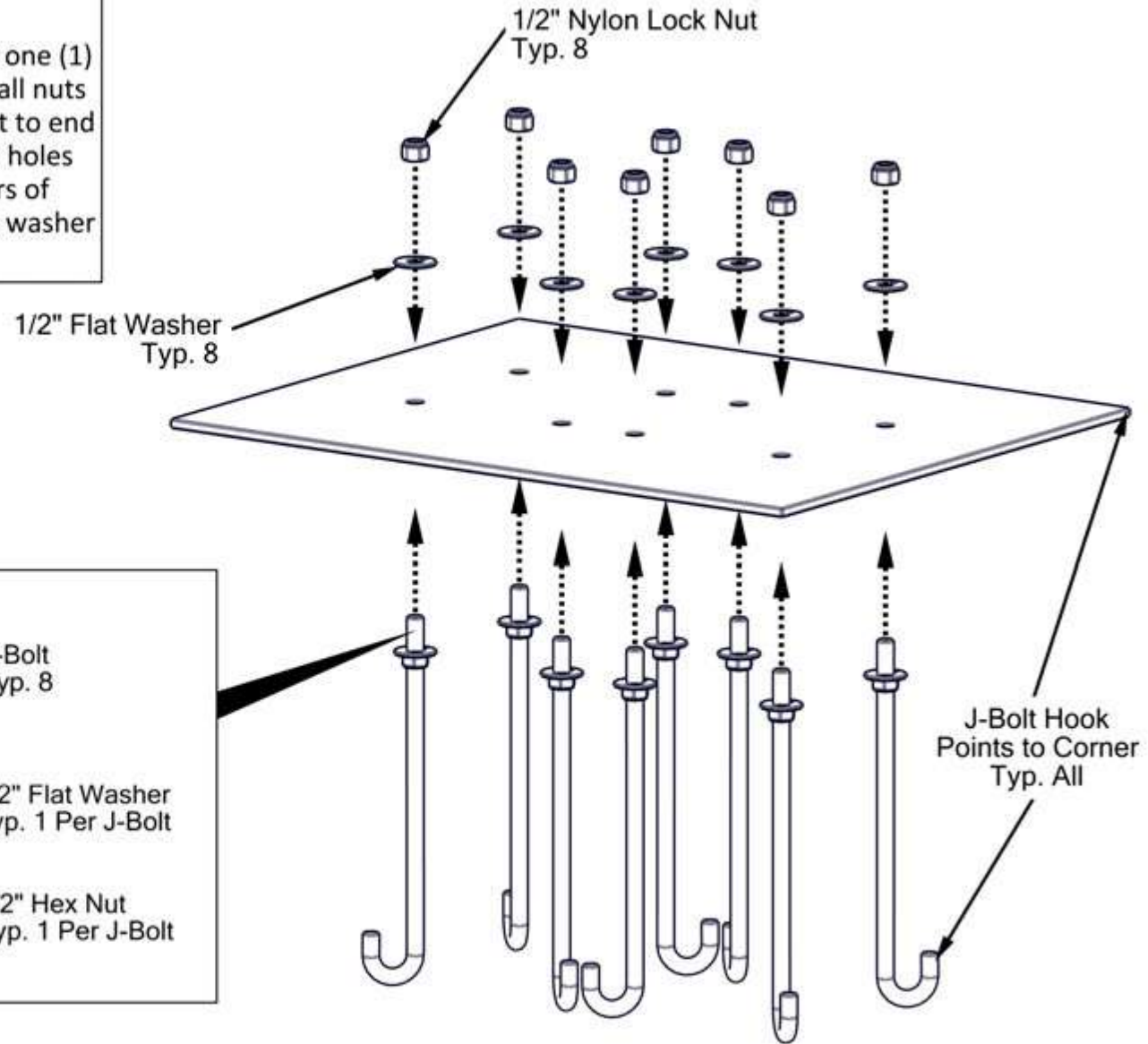

### Detail 2-1

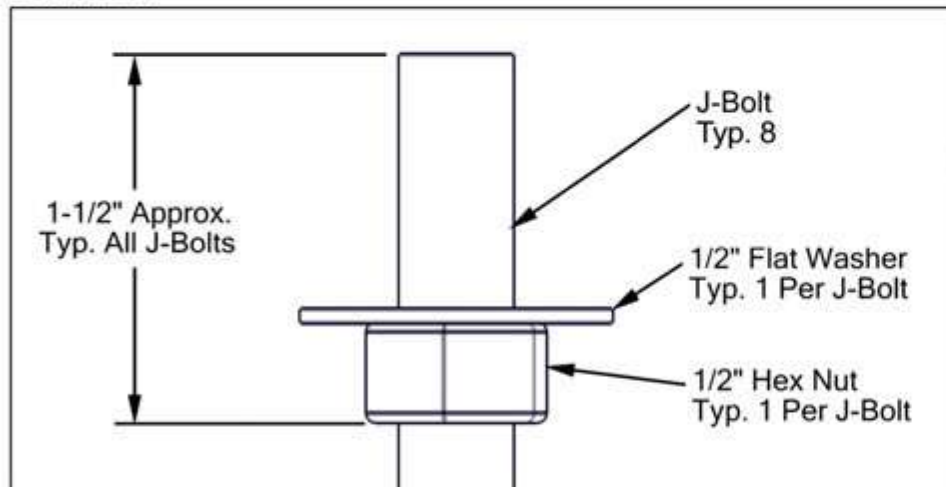

**STEP 3**

Prepare footing hole and set J-bolts. Concrete footing for J-bolts must be an 18" wide by 24" long oval 24" tall with 8" of concrete ABOVE GRADE and 16" of concrete BELOW GRADE. Position template 1-1/2" above top of concrete level so hex nuts can be adjusted. Hex nuts will be used to level spring rider. Center J-bolts on footing hole. Ensure template is level. Ensure template is fully supported. Fill footing hole and form to proper level. Bevel top edge of concrete to eliminate sharp corner. Allow concrete to fully cure based upon manufacturer's instructions before mounting spring rider.

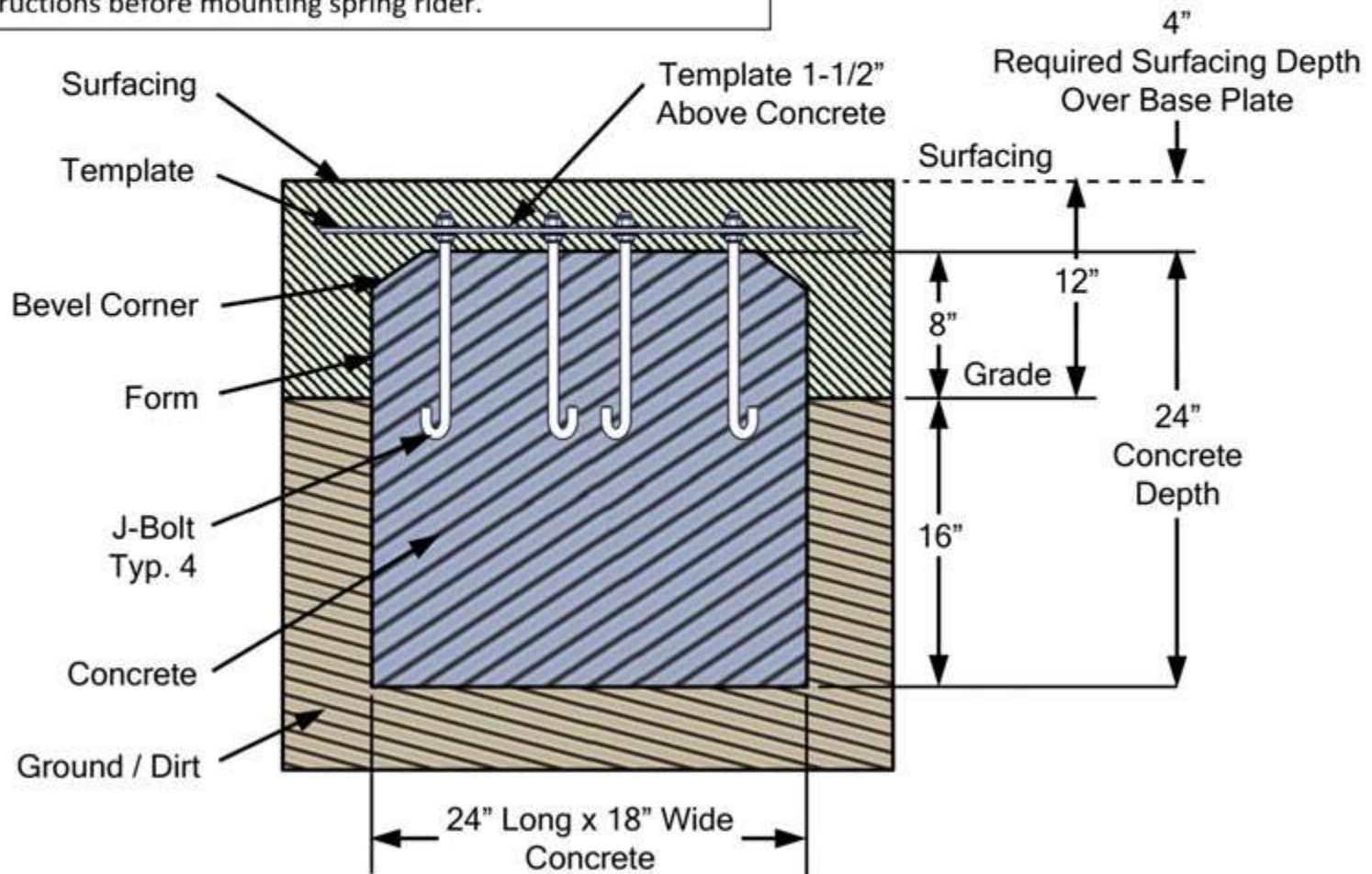



**STEP 4**

Mount side panels and foot pegs to middle panel. Side panels are left hand and right hand. Routed side of panel faces outward. Place two (2) side panels against each side of middle panel. Align holes in foot pegs with holes through all three (3) main panels. Insert two (2) 3/8" barrel nuts into each left foot peg. Secure through all three (3) main panels and through right foot pegs with two (2) 3/8" x 3" security Torx. At front forks and front wheel center, secure all three (3) panels together with one (1) 3/8" barrel nut and one (1) 3/8" x 2" security Torx. Ensure all edges of main panels are aligned. Do not fully tighten hardware. Hardware will be fully tightened at STEP 12. Proceed to STEP 5.

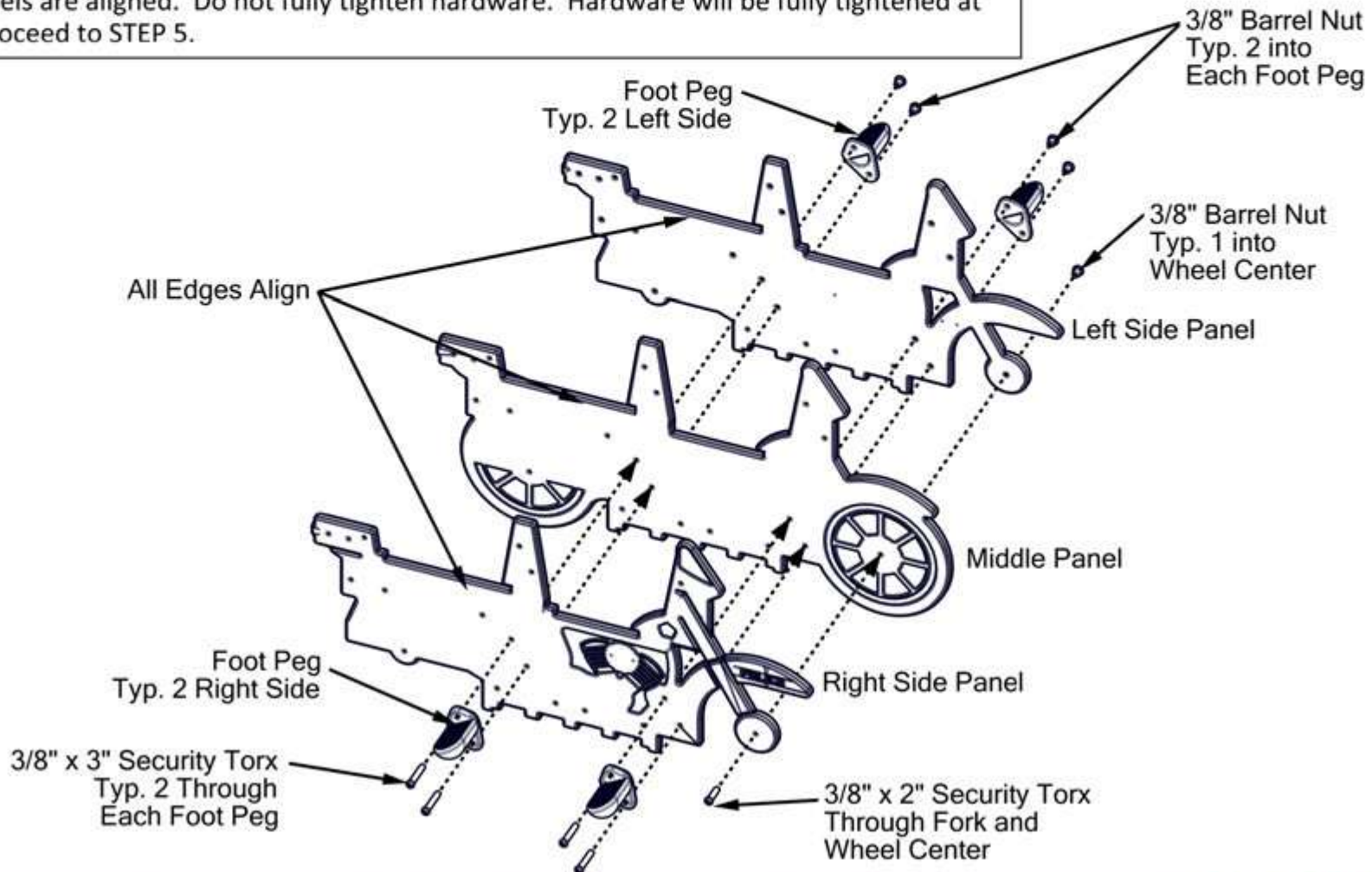

### STEP 5

Insert two (2) 3/8" barrel nuts into left marker panel. Secure right marker panel through three (3) main panels and to left marker panel with two (2) 3/8" x 3-1/2" security Torx. See Detail 5-1. Place left exhaust panel and right exhaust panel against sides of motorcycle. Align holes in tail pipes with holes in body. Secure with one (1) 3/8" barrel nut and one (1) 3/8" x 3-1/2" security Torx. At front end of right exhaust panel, drill two (2) 5/32" pilot holes through pre-drilled holes in exhaust panel and into body. Secure with two (2) 1/4" x 2" RSS screws. At front end of left exhaust panel, drill one (1) 5/32" pilot hole through pre-drilled hole in exhaust panel and into body. Secure with one (1) 1/4" x 2" RSS screw. Place one (1) cover panel on right side of body. Drill two (2) 5/32" pilot holes through pre-drilled holes in cover and into body. Secure with two (2) 1/4" x 2" RSS screws.

### Detail 5-1

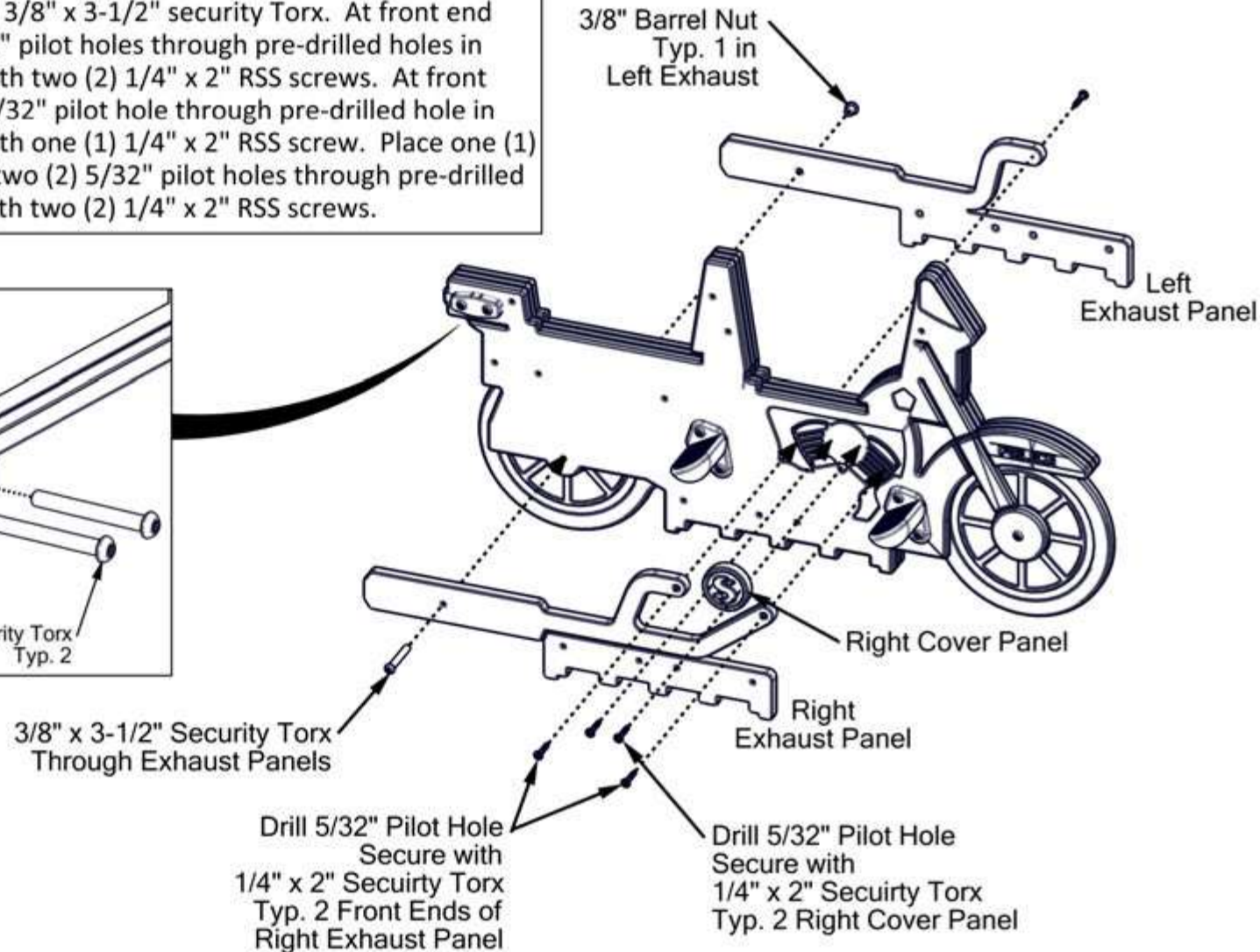
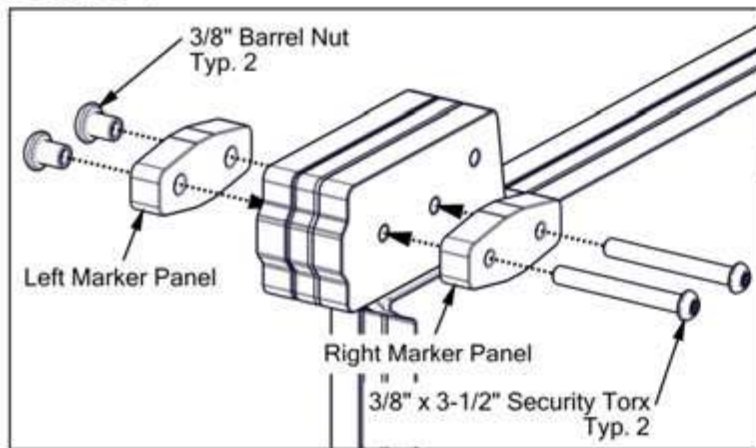



**STEP 6**

Insert two (2) 3/8" barrel nuts into left saddlebag panel. Secure right saddlebag panel through three (3) main panels and to left saddlebag panel with two (2) 3/8" x 3-1/2" security Torx. Place siren panel against left side of motorcycle. Align holes in siren with holes in body. Drill two (2) 5/32" pilot holes through pre-drilled holes in siren and into body. Secure with two (2) 1/4" x 2" RSS screws.

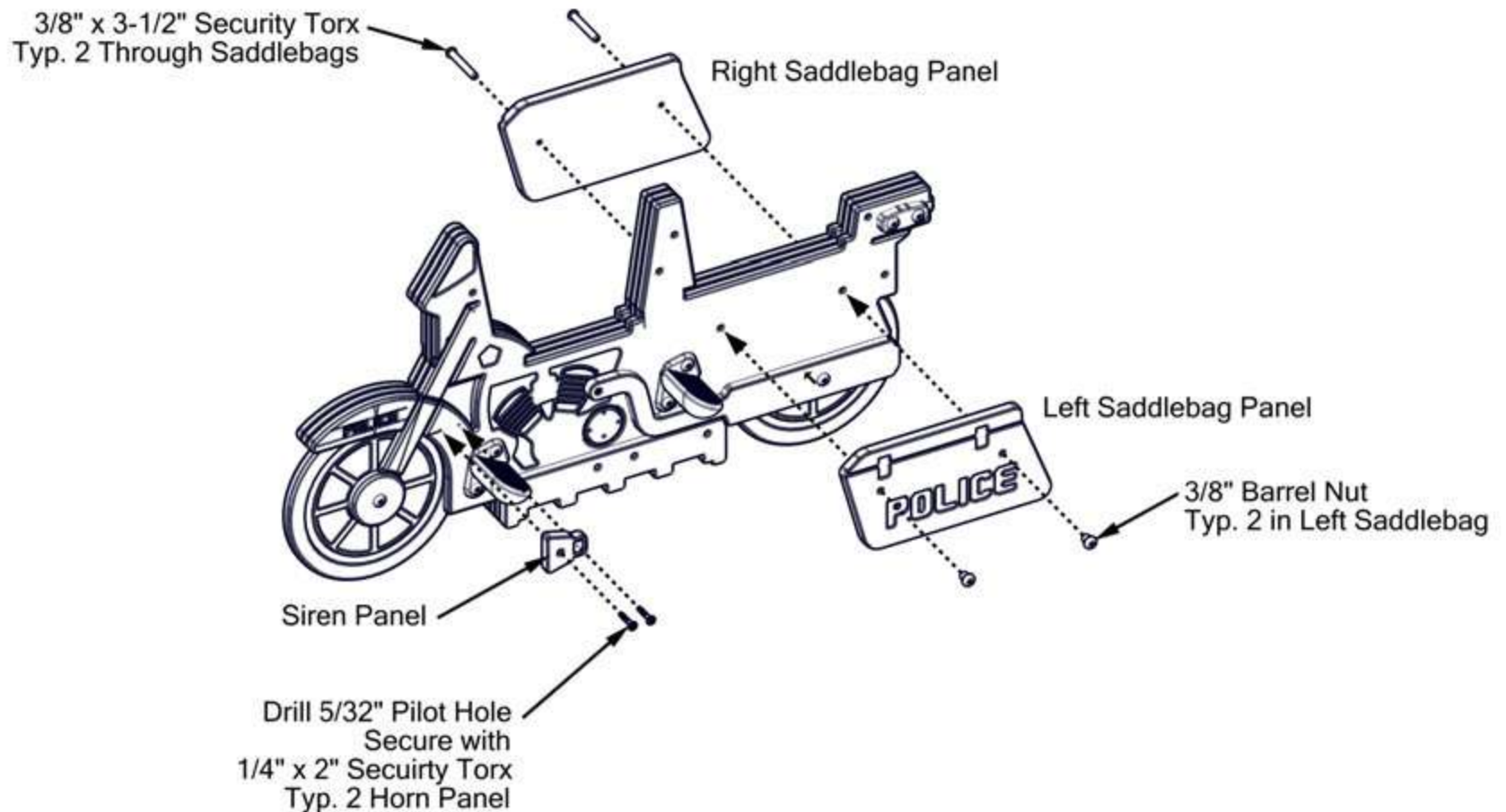



**STEP 7**

Place front and rear seat panels onto main panels. Front seat panel has longer notch. Ensure front notch in each seat panel fits around sides of main panels. Place seat back panel tabs into notches in rear of seat panels.

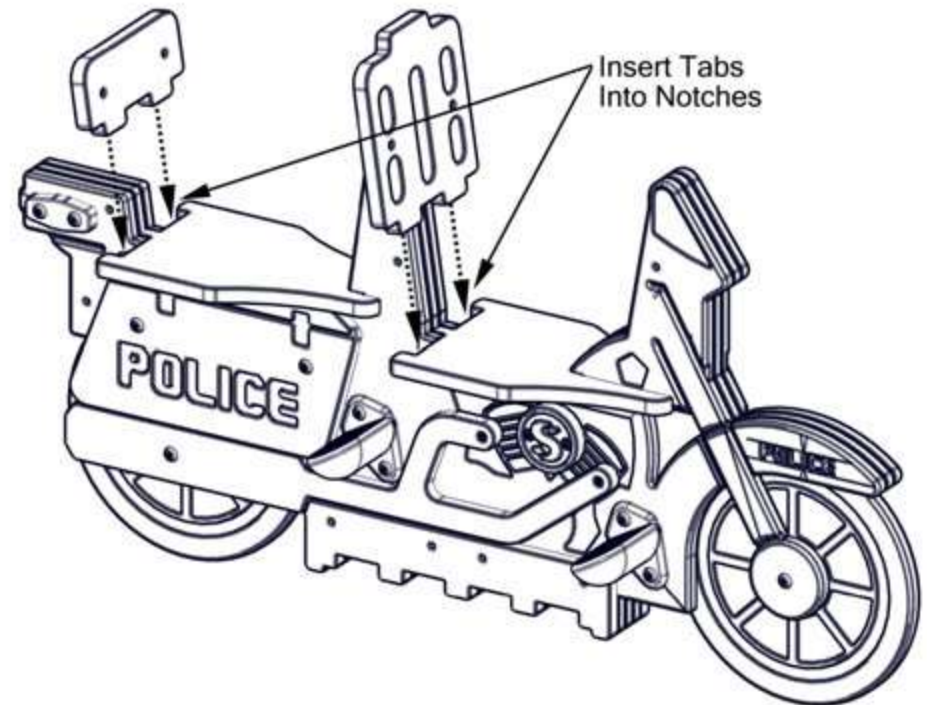
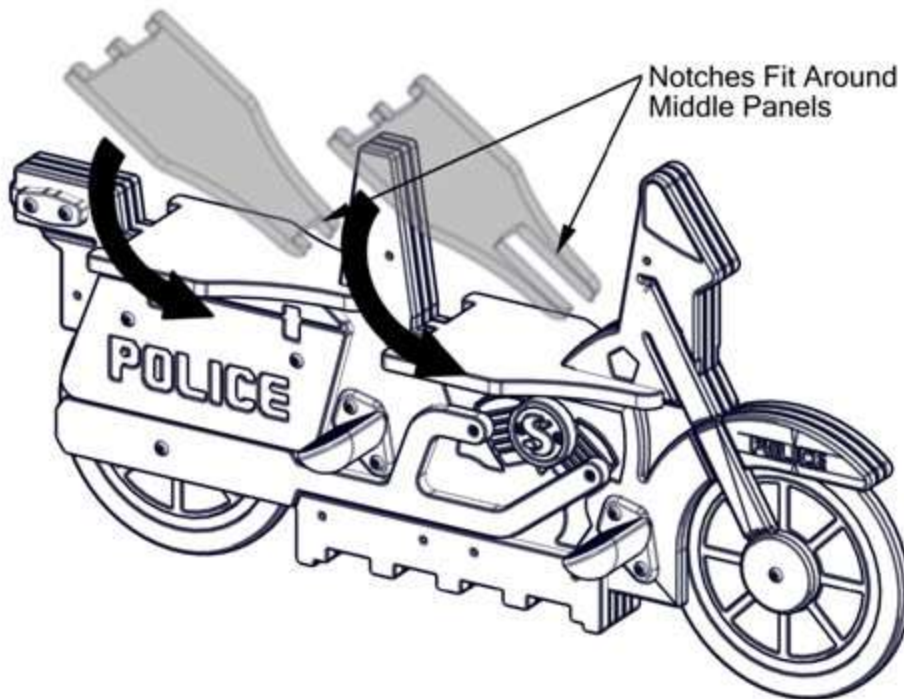

#### STEP 8

Secure seat backs panel to middle panels. At front seat back, place two (2) L-brackets on each side of middle panels. Long leg of L-brackets should be against seat back panel. Secure L-brackets to middle panels with one (1) 3/8" barrel nut, one (1) 3/8" x 7/8" flat washer, and one (1) 3/8" x 2-1/4" security Torx. Secure L-brackets to seat back panel with two (2) 3/8" barrel nuts, two (2) 3/8" x 7/8" flat washers, and two (2) 3/8" x 3/4" security Torx. See Detail 8-1. Repeat STEP 8 for rear seack back panel.

#### Detail 8-1

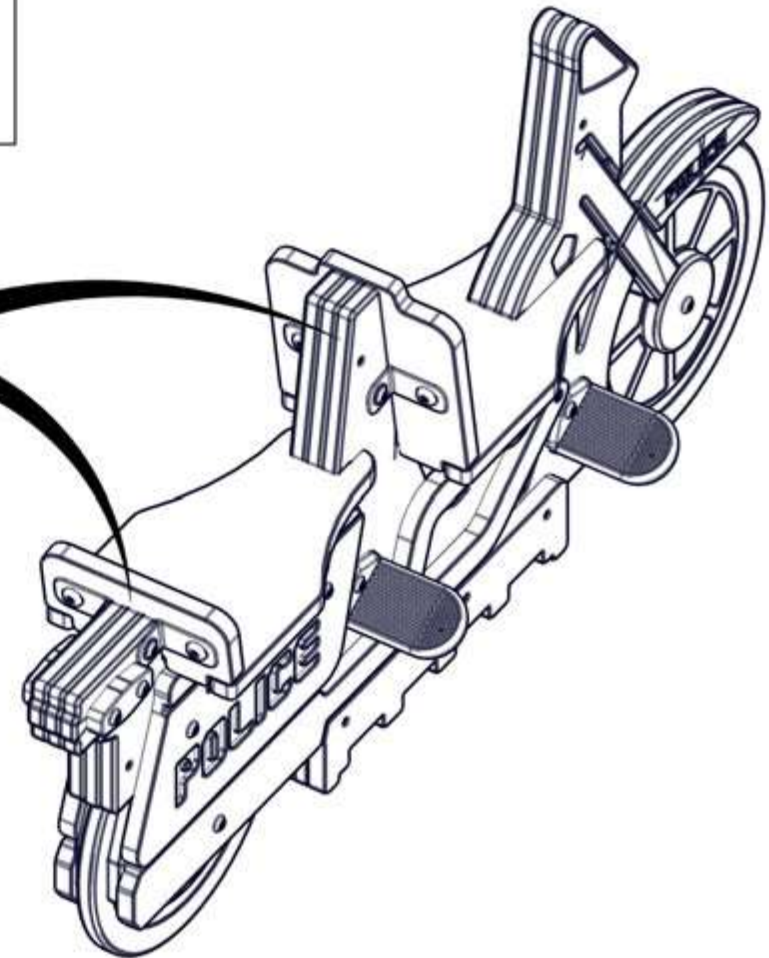
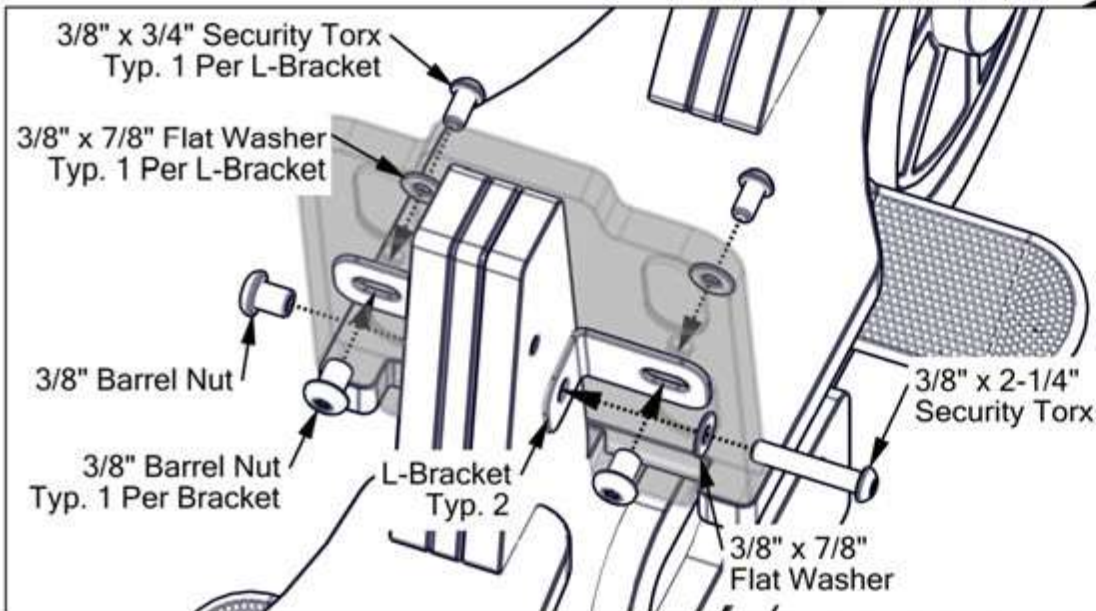



**STEP 9**

Secure steering panels to middle panels. At front steering panel, place two (2) L-brackets on each side of middle panels. Long leg of L-brackets should be against steering panel. Secure L-brackets to middle panels with one (1) 3/8" barrel nut, one (1) 3/8" x 7/8" flat washer, and one (1) 3/8" x 2-1/4" security Torx. Secure L-brackets to steering panel with two (2) 3/8" barrel nuts, two (2) 3/8" x 7/8" flat washers, and two (2) 3/8" x 3/4" security Torx. See Detail 9-1. Repeat STEP 9 for rear steering panel.

Detail 9-1

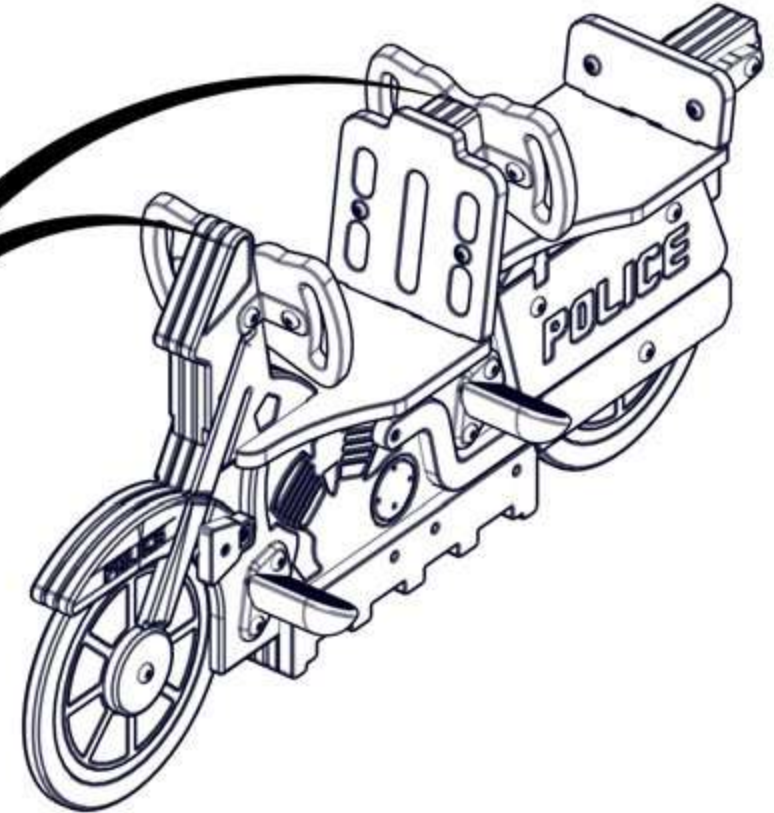
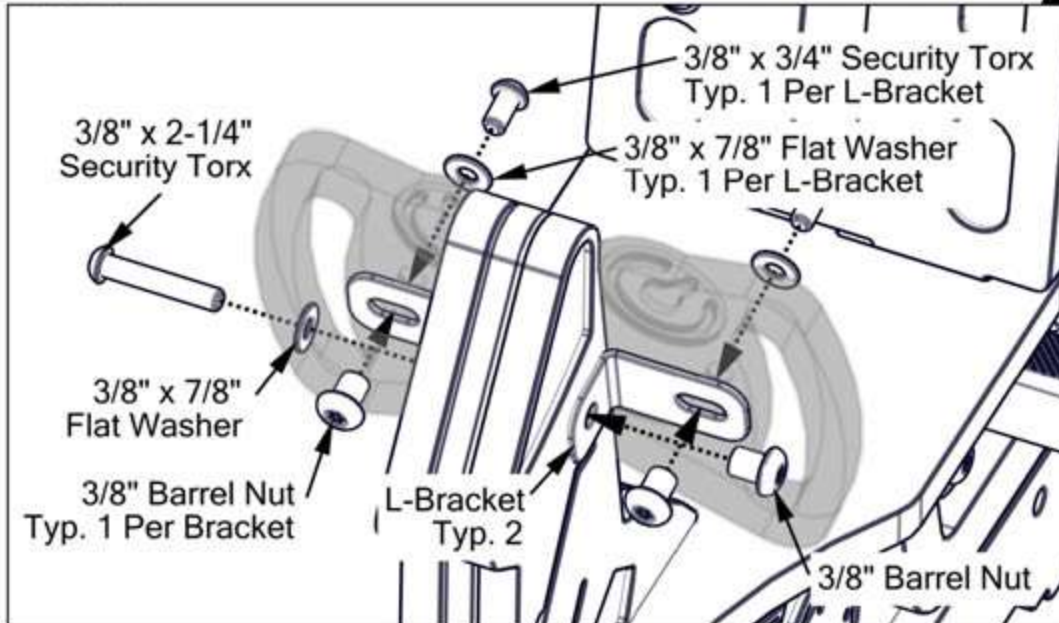

**STEP 10**

Secure headlight assembly to middle panels. Place two (2) L-brackets on each side of middle panels. Long leg of L-brackets should be against frame panel. Secure L-brackets to middle panels with one (1) 3/8" barrel nut, one (1) 3/8" x 7/8" flat washer, and one (1) 3/8" x 2-1/4" security Torx. Align holes in blinker panels with holes in frame panel. Secure L-brackets to frame panel and blinker panels with two (2) 3/8" barrel nuts and two (2) 3/8" x 1-1/4" security Torx. Place headlight panel between blinker panels. Drill two (2) 5/32" pilot holes through pre-drilled holes in headlight panel and into frame panel and middle panel. Secure with two (2) 1/4" x 2" RSS screws. See Detail 10-1.

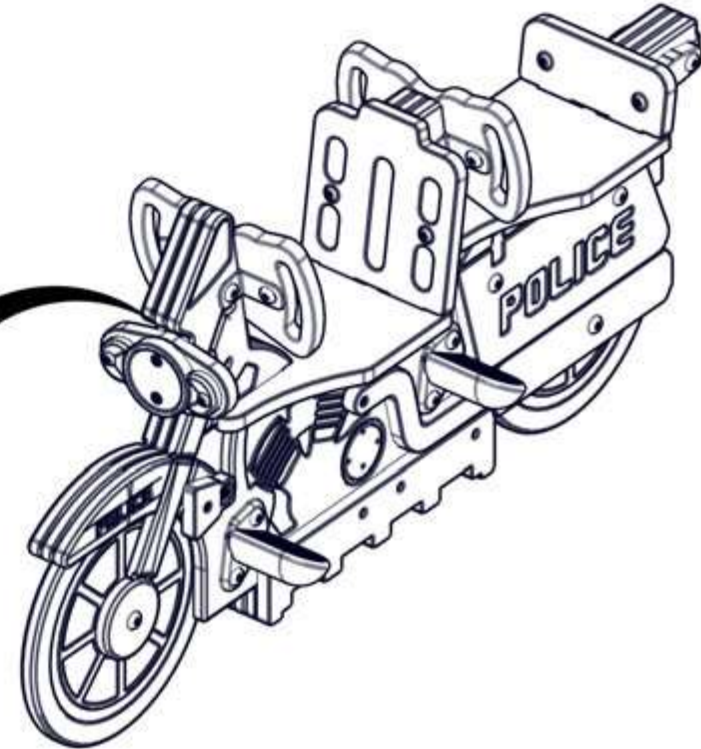
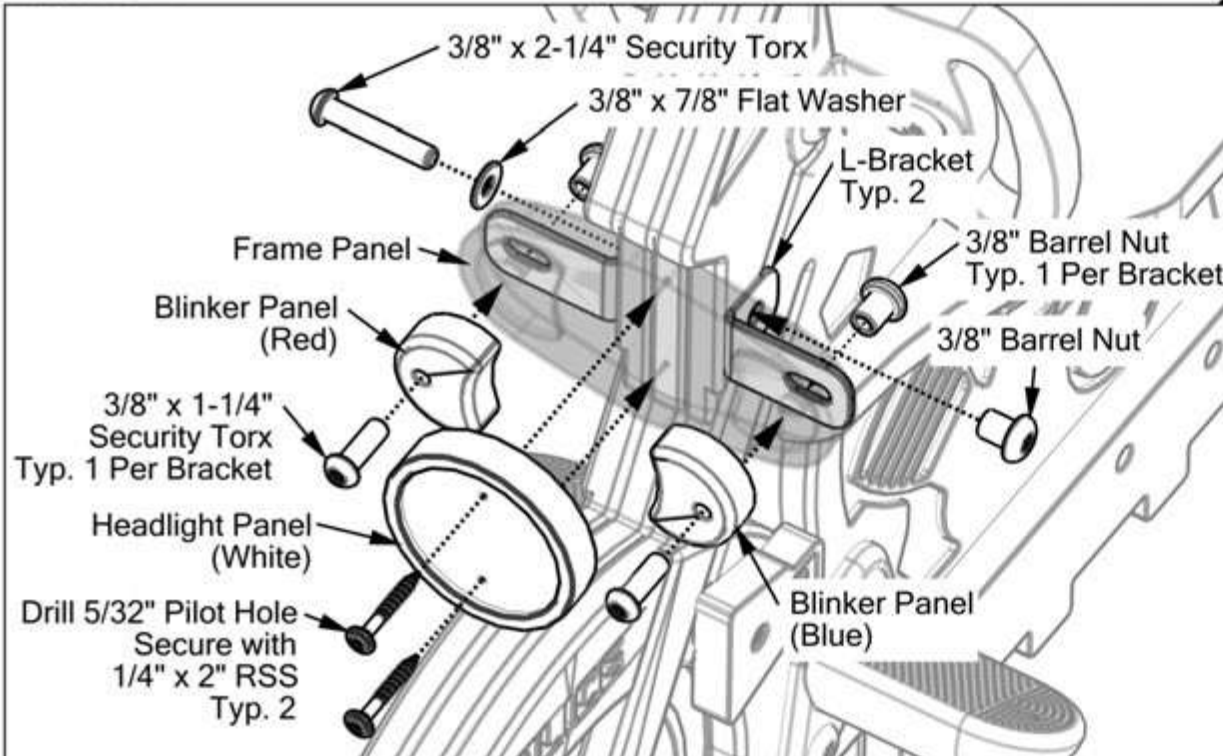
**Detail 10-1**



**STEP 11**

Secure tail light assembly to middle panels. Place two (2) L-brackets on each side of middle panels. Long leg of L-brackets should be against frame panel. Secure L-brackets to middle panels with one (1) 3/8" barrel nut, one (1) 3/8" x 7/8" flat washer, and one (1) 3/8" x 2-1/4" security Torx. Align holes in red blinker panels with holes in frame panel. Secure L-brackets to frame panel and red blinker panels with two (2) 3/8" barrel nuts and two (2) 3/8" x 1-1/4" security Torx. Place tail light panel between blinker panels. Drill two (2) 5/32" pilot holes through pre-drilled holes in tail light panel and into frame panel and middle panel. Secure with two (2) 1/4" x 2" RSS screws. See Detail 11-1.

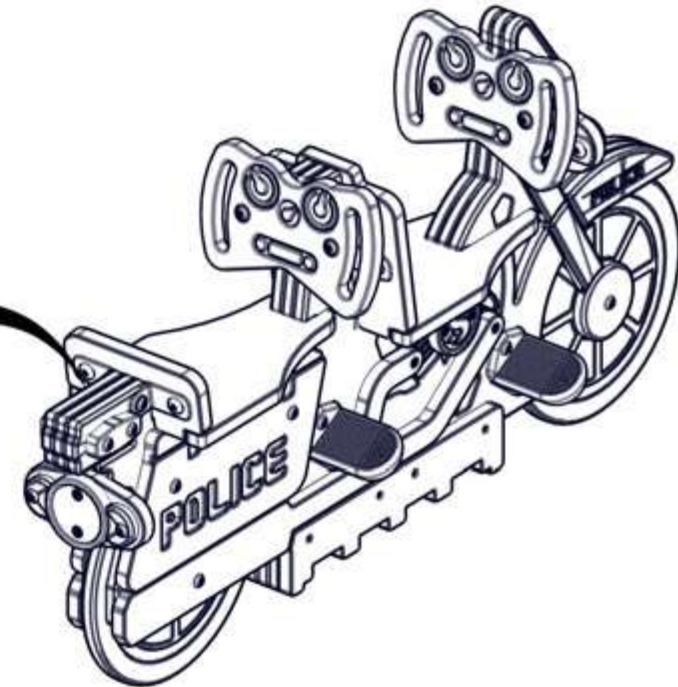
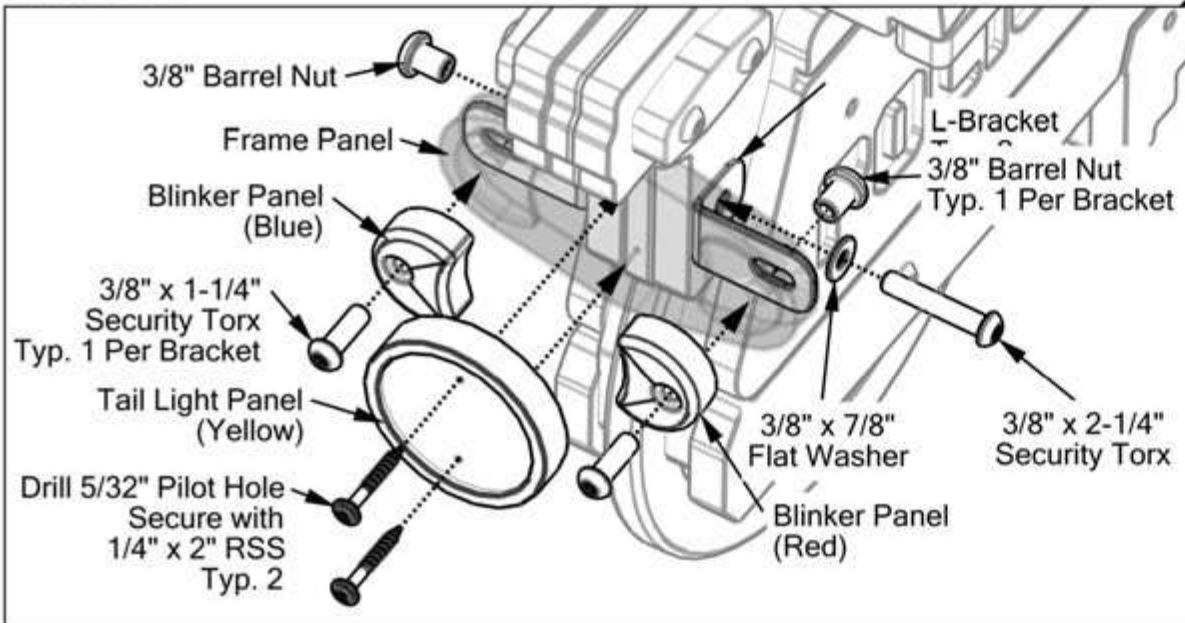
**Detail 11-1**

STEP 12

Mount rider assembly to spring assemblies. Position tops of springs as shown below. Align all holes through spring assemblies and main panels. Secure with four (4) 3/8" barrel nuts, four (4) 3/8" x 1" flat washers, and four (4) 3/8" x 4" security Torx. Fully tighten ALL assembly hardware NOW.

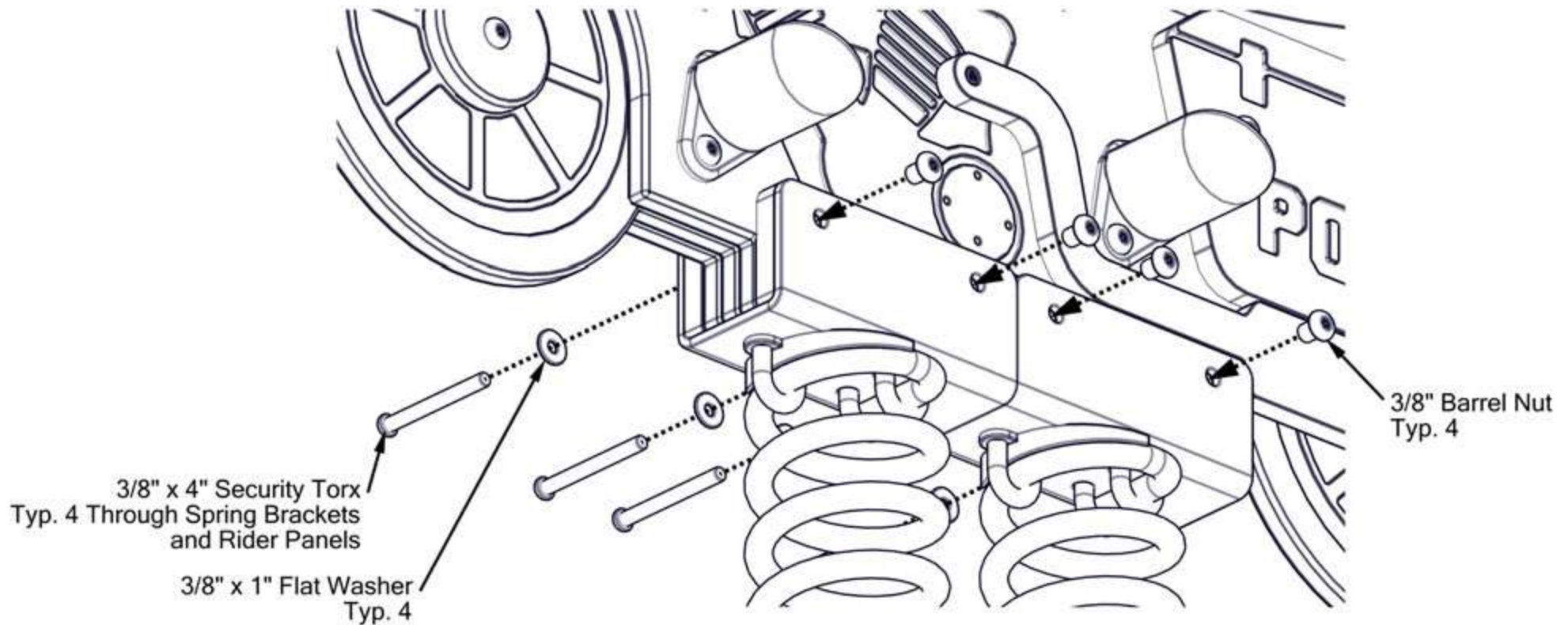

Tighten ALL Assembly Hardware NOW



### STEP 13

Ensure concrete is fully cured. Remove top 1/2" lock nuts and 1/2" flat washers. Remove template. Place spring rider assembly onto J-bolts. Replace 1/2" flat washers and 1/2" lock nuts. Elevation of rider seat above finished surfacing **MUST BE 14" to 28"**. See Detail 13-1. Adjust 1/2" nuts below and above rider base plate to level rider. Check all connections and ensure structure is stable. Installation is complete. Place one (1) Age Appropriate Sticker on structure in a clearly visible location.

Detail 13-1

