

USER GROUP: 2-5 Years

RECOMMENDED CREW: 1-2 People

TOOLS REQUIRED:

- TT-45 Torx, 3/4" Hex
- Level, Square
- Auger / Post Hole Digger / Shovel
- Drill Bits: 5/8"
- High Speed 3/8" Electric Drill with Clutch
- Wood / Plastic Saw
- Concrete Tube Form - 18" Diameter

NOTE: Use of any other driver may result in damage to tool and/or hardware!

INSTALLATION TIME: 1 Hour

WEIGHT: 140 lbs.

CONCRETE REQUIRED: (8.3) 80lb. bags - 5.0 ft<sup>3</sup>

NOTE: Concrete must have a minimum rating of 2,500 psi and must be mixed per manufacturer's recommendations.

**PRE-INSTALLATION CHECK:**

Customer is responsible for verifying materials received by comparing received items with packing list. If any parts are missing or damaged, contact your local sales representative immediately.

Supplier is not responsible for items discovered missing after 72 hours from time of delivery.

Before beginning installation, all installers must read and understand the Installation Introduction manual as supplied. If you did not receive a copy, or if you have any questions regarding any information in the Installation Instructions or this Installation Guideline, contact your local sales representative.

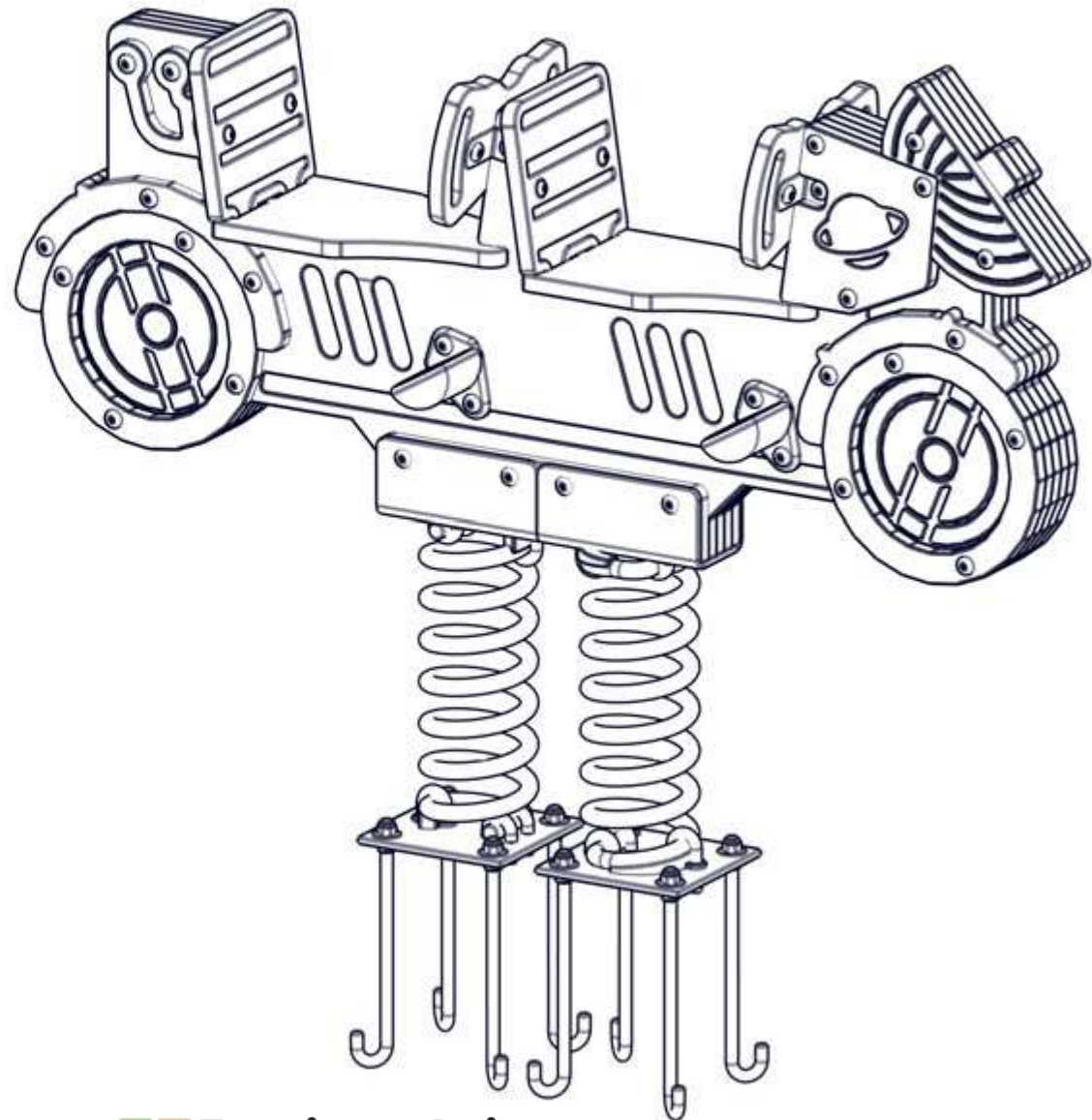



# Spring Rider - Moon Buggy - 2 Seat - Double Spring • Model TFS0031XX

## INSTALLATION GUIDELINE

ITEM	Part No.	QTY	DESCRIPTION
1	RSP-3891XX	1	Sheet - Moon Buggy Spring Rider Center Body Panel
2	RSP-3864XX	1	Sheet - Moon Buggy Spring Rider Left Body Panel
3	RSP-3831XX	1	Sheet - Moon Buggy Spring Rider Right Body Panel
4	RSP-1102XX	2	Sheet - Steering Wheel Spring Rider
5	RSP-3865XX	2	Sheet - Moon Buggy Spring Rider Seat Bottom
6	RSP-3867XX	2	Sheet - Moon Buggy Spring Rider Seat Back
7	RSP-3947-01	2	Sheet - Moon Buggy Spring Rider Left Wheel
8	RSP-3869-01	2	Sheet - Moon Buggy Spring Rider Right Wheel
9	RSP-3923-21	1	Sheet - Moon Buggy Spring Rider Left Dish Panel
10	RSP-3910-21	1	Sheet - Moon Buggy Spring Rider Right Dish Panel
11	RSP-3925XX	1	Sheet - Moon Buggy Spring Rider Left Front Fender
12	RSP-3873XX	1	Sheet - Moon Buggy Spring Rider Right Front Fender
13	RSP-3924XX	1	Sheet - Moon Buggy Spring Rider Left Rear Fender
14	RSP-3871XX	1	Sheet - Moon Buggy Spring Rider Right Rear Fender
15	RSP-3921-01	1	Sheet - Moon Buggy Spring Rider Left Antenna Panel
16	RSP-3911-01	1	Sheet - Moon Buggy Spring Rider Right Antenna Panel
17	RSP-3920XX	1	Sheet - Moon Buggy Spring Rider Left Planet Panel
18	RSP-3909XX	1	Sheet - Moon Buggy Spring Rider Right Planet Panel
19	RSP-3945XX	1	Sheet - Moon Buggy Spring Rider Left Filler Panel
20	RSP-3946XX	1	Sheet - Moon Buggy Spring Rider Right Filler Panel
21	30218101XX	4	Foot Peg - Aluminum W/Two Mounting Holes (COATED)
22	30318103XX	8	L-BRKT 2 3/4" X 1 3/4" X 1-1/2" (Coated)
23	HWB0513	4	Bolt 3/8"- x 4" TORX Security with Patch
24	HWS0097	22	Bolt - 3/8"-16 x 3-1/2" Security Torx With Patch
25	HWB0240	4	Bolt 3/8"-16 x 3" TORX Security with Patch
26	HWB0305	4	Bolt 3/8"-16 x 2-1/4" TORX Security with Patch
27	HWB0315	8	Bolt 3/8"-16 x 3/4" TORX Security with Patch
28	HWWR0075	4	Washer 3/8" ID x 1" OD Flat - 300 Series SS
29	HWWR0165	18	Washer 3/8" ID x 7/8" OD General Purpose SS
30	HWN0128	42	Nut 3/8"-16 302 SS TORX Barrel
31	MTA39809XX	2	Coil Spring U-Brtk Asm.
32	HWA0009	8	Anchor 1/2" x 12-1/2" SS J-Bolt
33	HWN0014	8	Nut 1/2"-13 Hex - Zinc plated
34	HWN0025	8	Nut 1/2"-13 - Nylock - 316SS
35	HWWR0022	16	Washer 1/2" ID x 1 1/4" Flat Washer 316SS

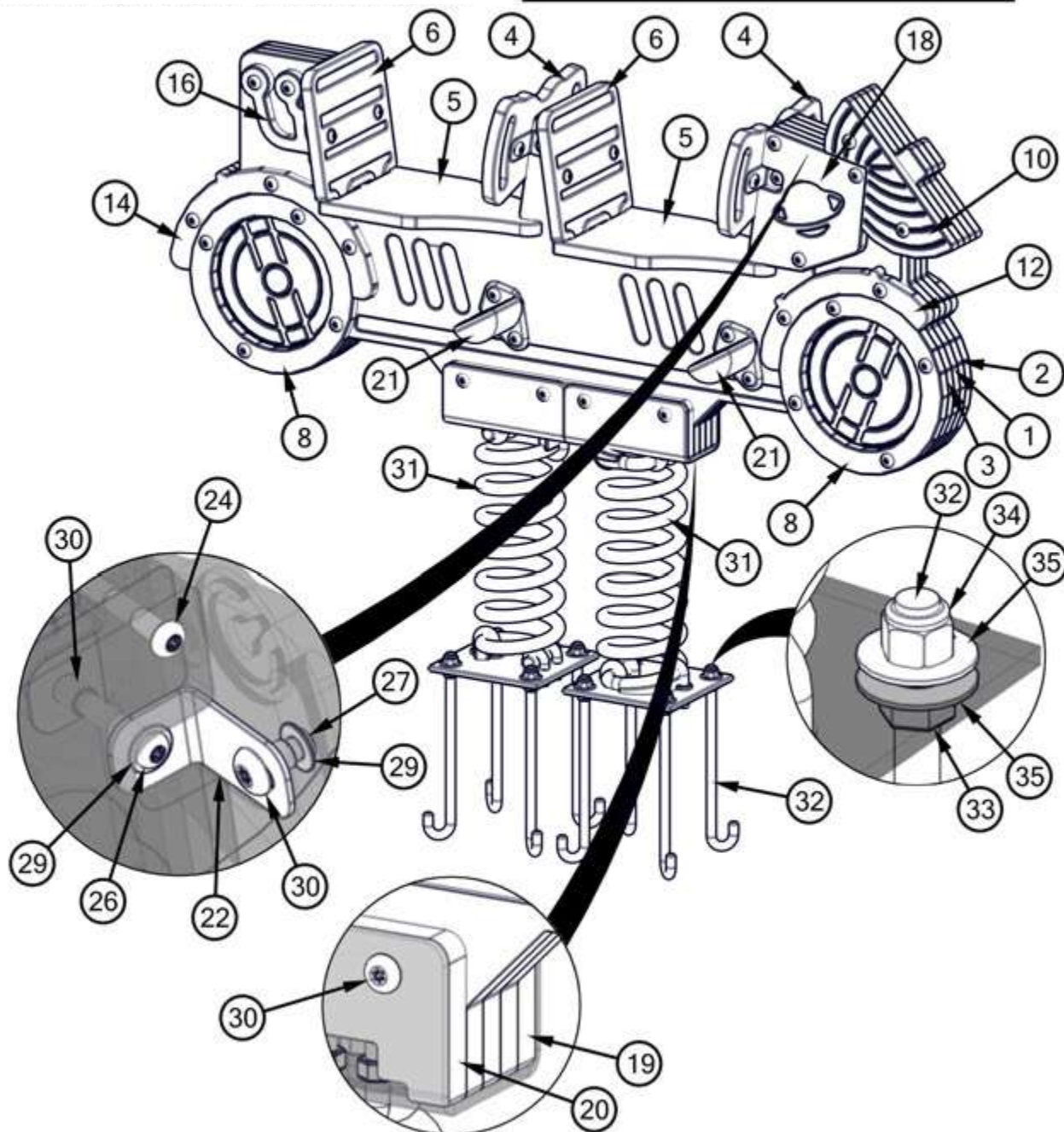

**STEP 1**

Use scrap poly sheet, plywood, etc. (not included) to create anchor bolt template. Cut a rectangle piece of material to a minimum of 26" x 20". Center template on spring base plates. At each hole in spring base plates, drill one (1) 5/8" hole through template.

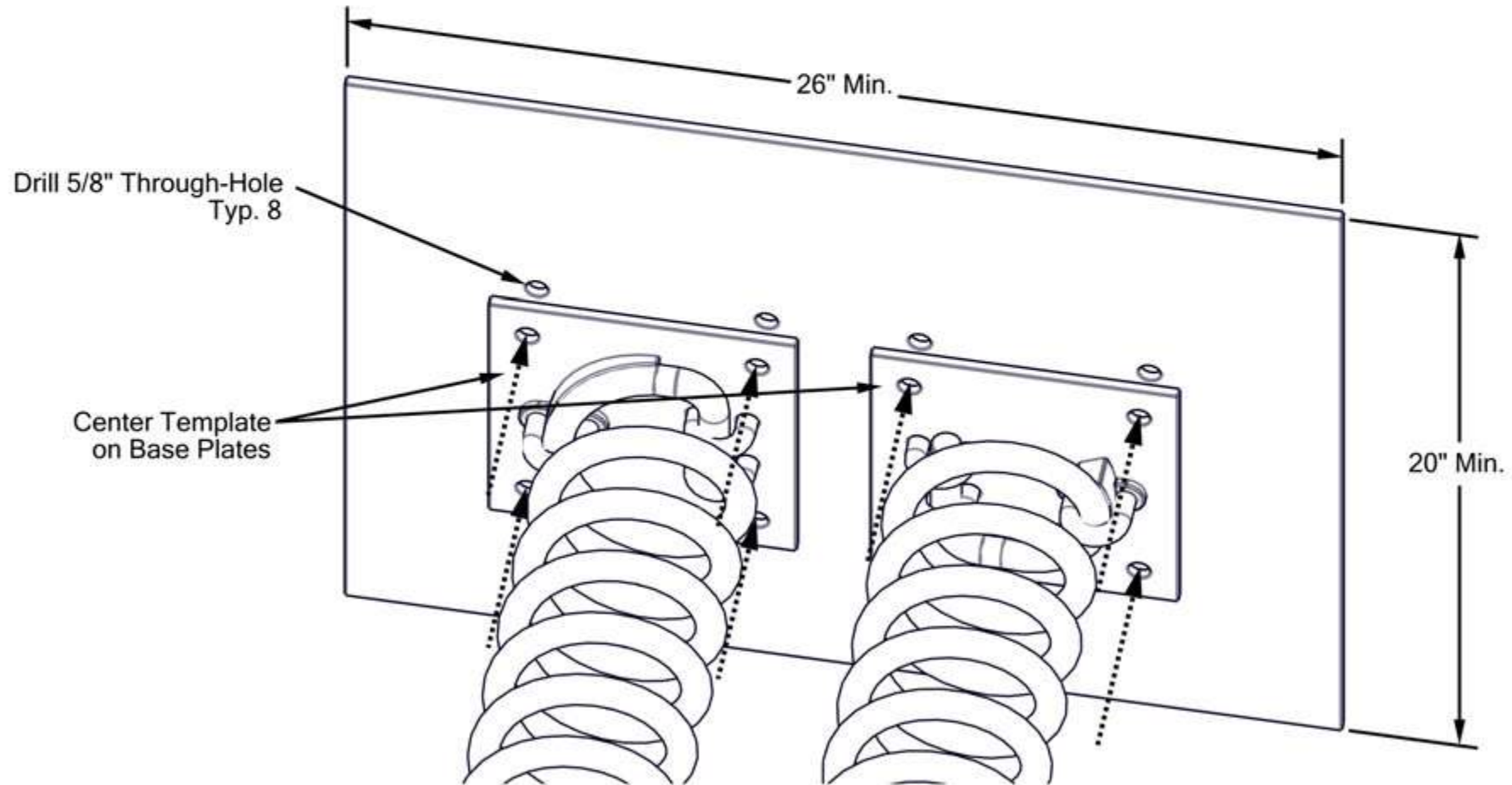



## INSTALLATION GUIDELINE

### STEP 2

Mount J-bolts to template. For each J-bolt, mount one (1) 1/2" hex nut and one (1) 1/2" flat washer. Ensure all nuts and washers are same distance from bottom of nut to end of J-bolt. See Detail 2-1. Place each J-bolt through holes in template. Hook of J-bolts should point to corners of template. Secure each J-bolt with one (1) 1/2" flat washer and one (1) 1/2" Nylon lock nut.

### Detail 2-1

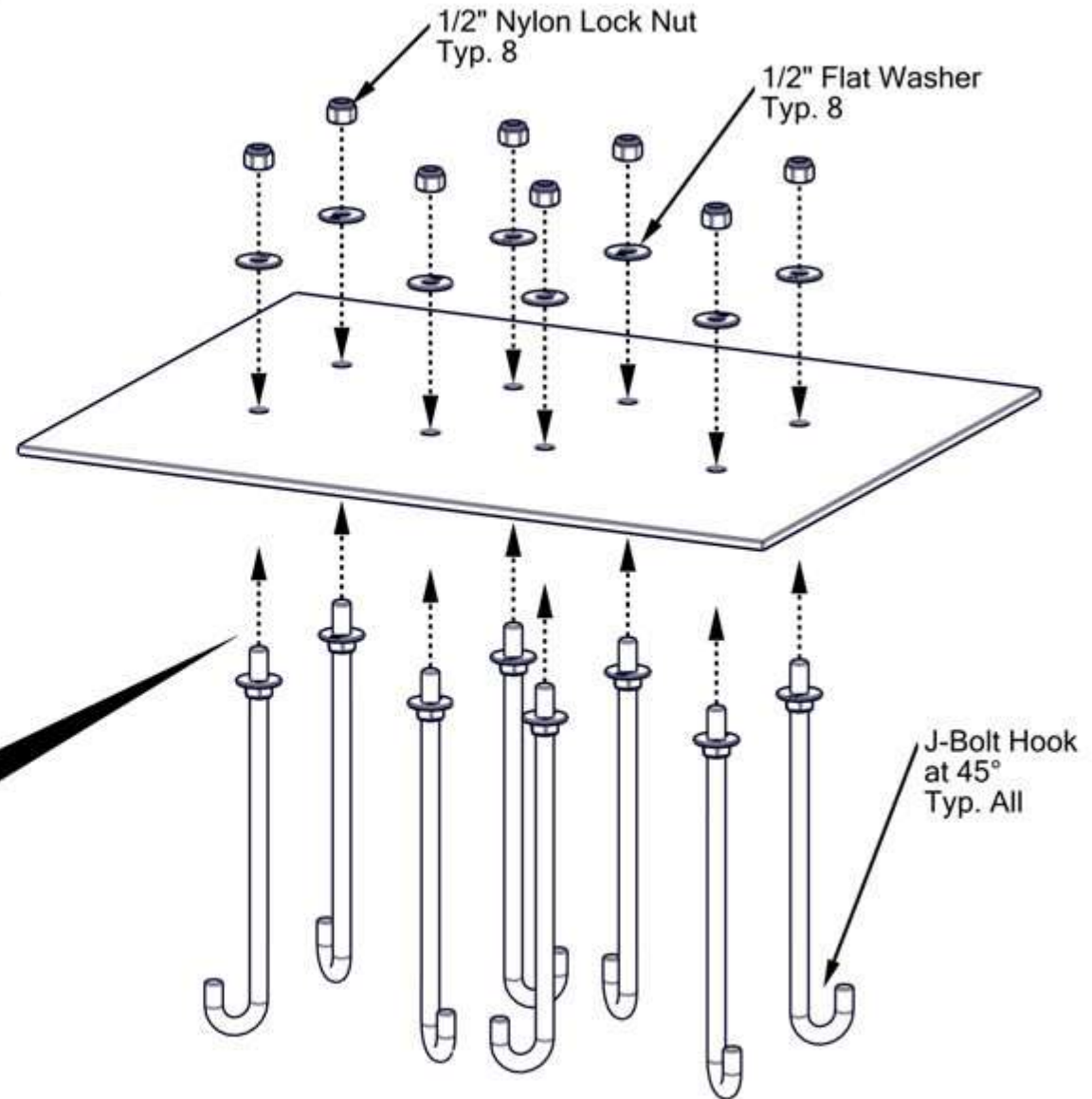
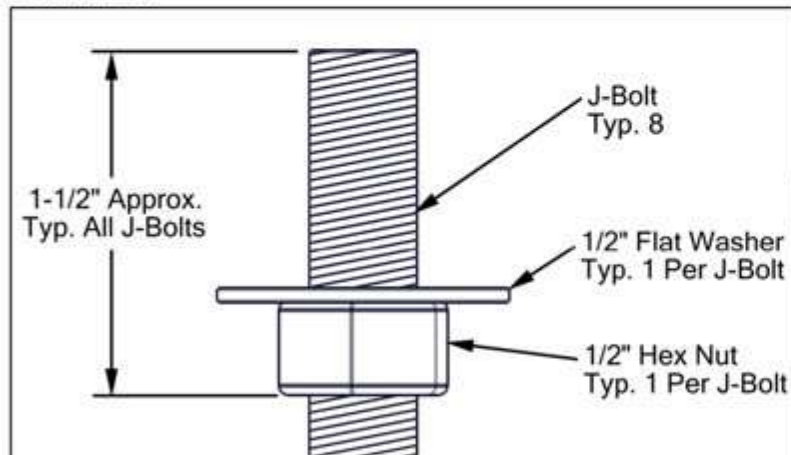

**STEP 3**

Prepare footing hole and set J-bolts. Concrete footing for J-bolts must be an 18" wide by 24" long oval with 8" of concrete ABOVE GRADE and 16" of concrete BELOW GRADE. Position template 1-1/2" above top of concrete level so hex nuts can be adjusted. Hex nuts will be used to level spring rider. Center J-bolts on footing hole. Ensure template is level. Ensure template is fully supported. Fill footing hole and form to proper level. Bevel top edge of concrete to eliminate sharp corner. Allow concrete to fully cure based upon manufacturer's instructions before mounting spring rider.

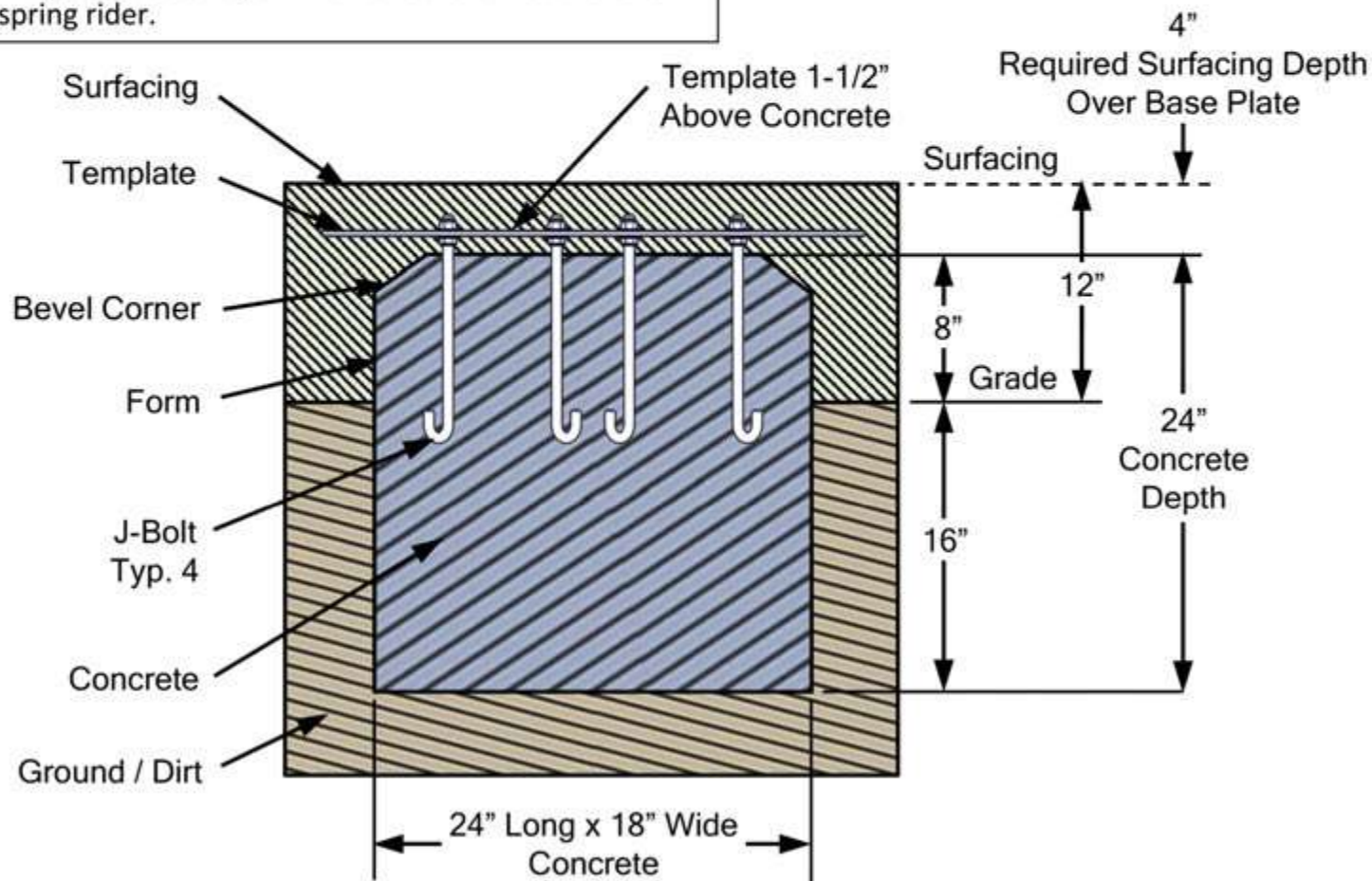



**INSTALLATION GUIDELINE****STEP 4**

Connect main panels and foot pegs together. Insert four (4) 3/8" barrel nuts into two (2) foot pegs. Insert four (4) 3/8" barrel nuts into right antenna panel. Align holes in right main panel, center main panel, and left main panel. Secure left foot pegs to right foot pegs with four (4) 3/8" x 3" security Torx. Secure left antenna panel through main panels and to right antenna panel with four (4) 3/8" x 3-1/2" security Torx.

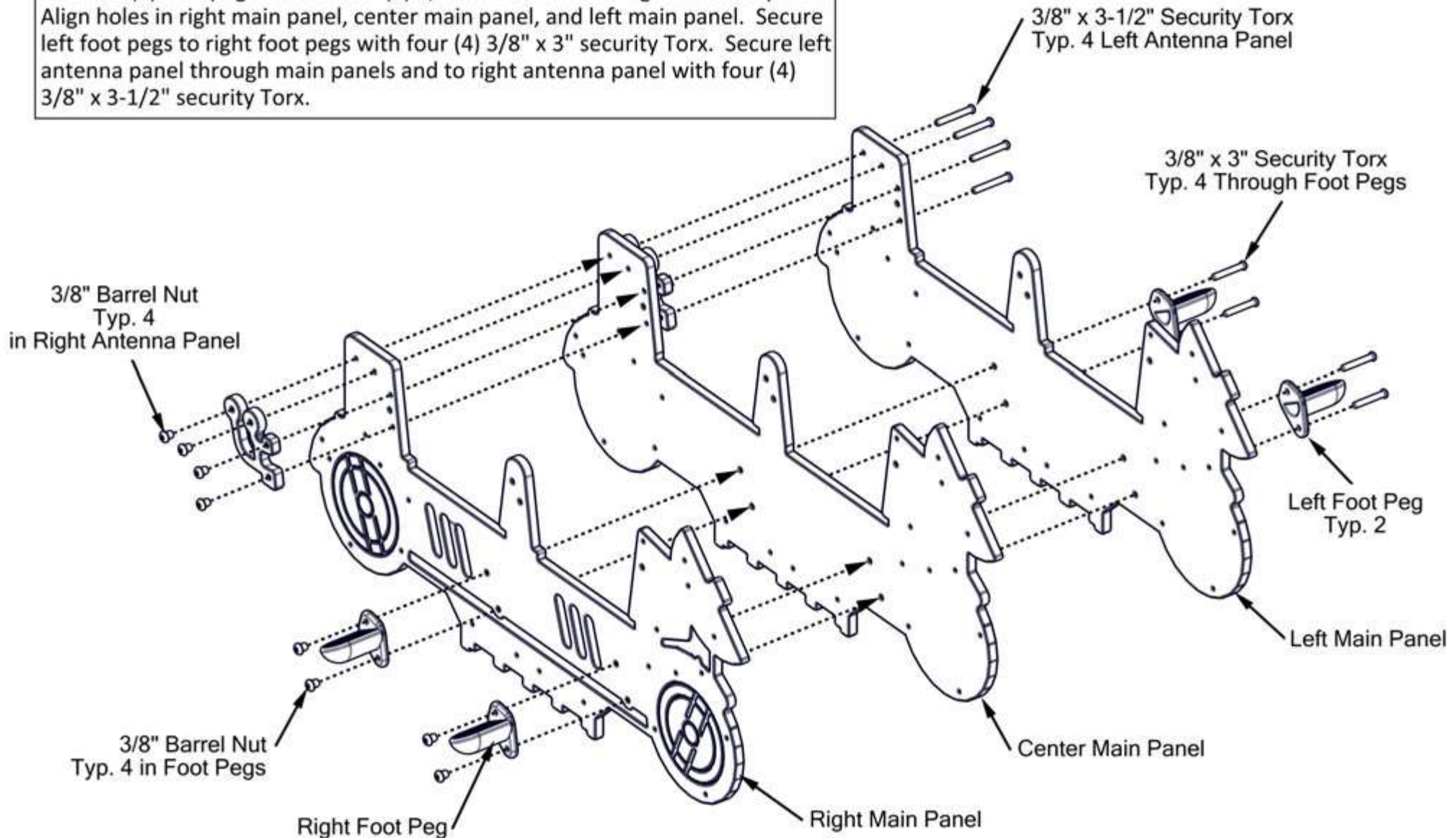

### STEP 5

Mount remaining left and right trim panels as shown below. Insert 3/8" barrel nuts into all right trim panels. Align holes in right trim panels and main assembly. Secure left trim panels through main assembly and to right trim panels with 3/8" x 3-1/2" security Torx.

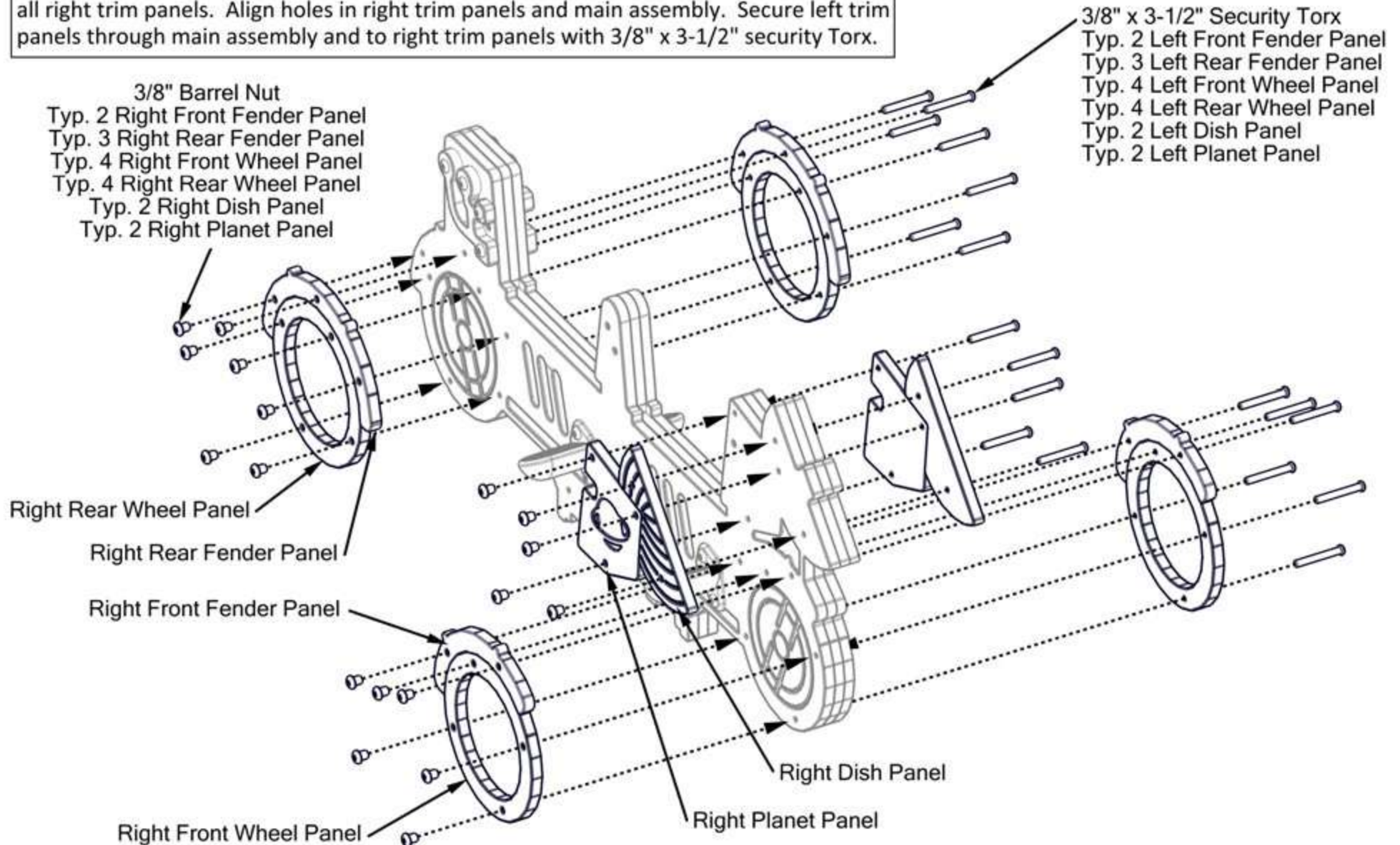



**STEP 6**

Place seat panels onto main assembly. Ensure front notches in seat panels fit around sides of main assembly. Place back panel tabs into notches in rear of seat panels.

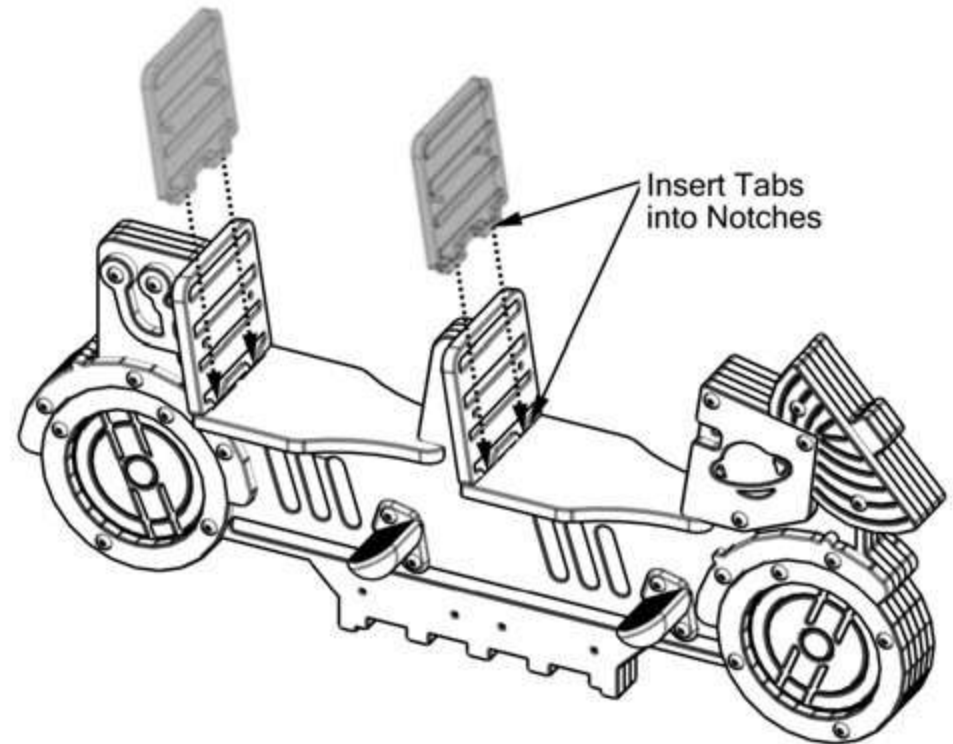
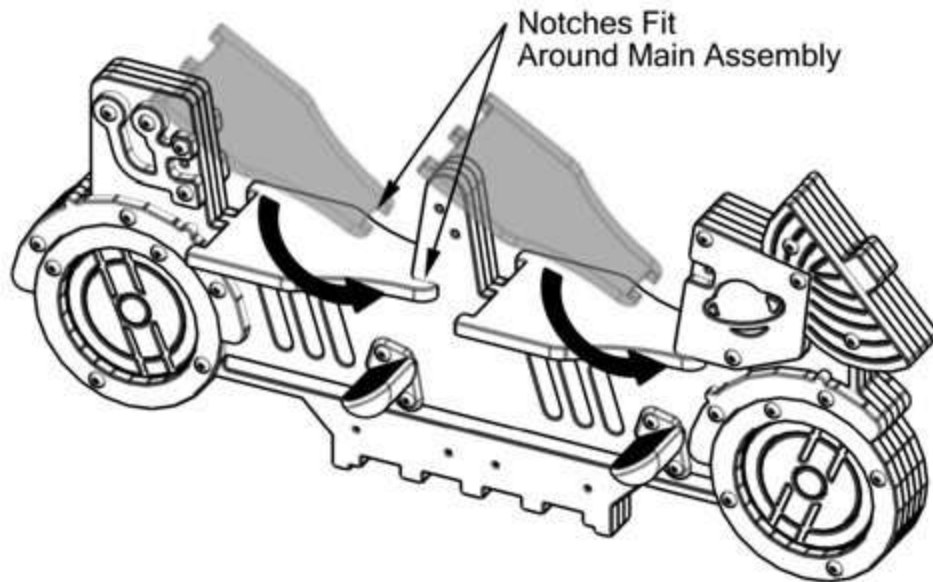



**INSTALLATION GUIDELINE**

**STEP 7**

Secure seat back panels to main assembly. For each seat back panel, place two (2) 2-3/4" x 1-3/4" x 1-1/2" L-brackets against back of seat panel. Insert three (3) 3/8" barrel nuts in seat panel and right main panel. Secure brackets to main assembly with one (1) 3/8" x 7/8" flat washer and one (1) 3/8" x 2-1/4" security Torx. Secure brackets to seat panel with two (2) 3/8" x 7/8" flat washers and two (2) 3/8" x 3/4" security Torx. See Detail 7-1. Repeat for second seat back panel.

**Detail 7-1**

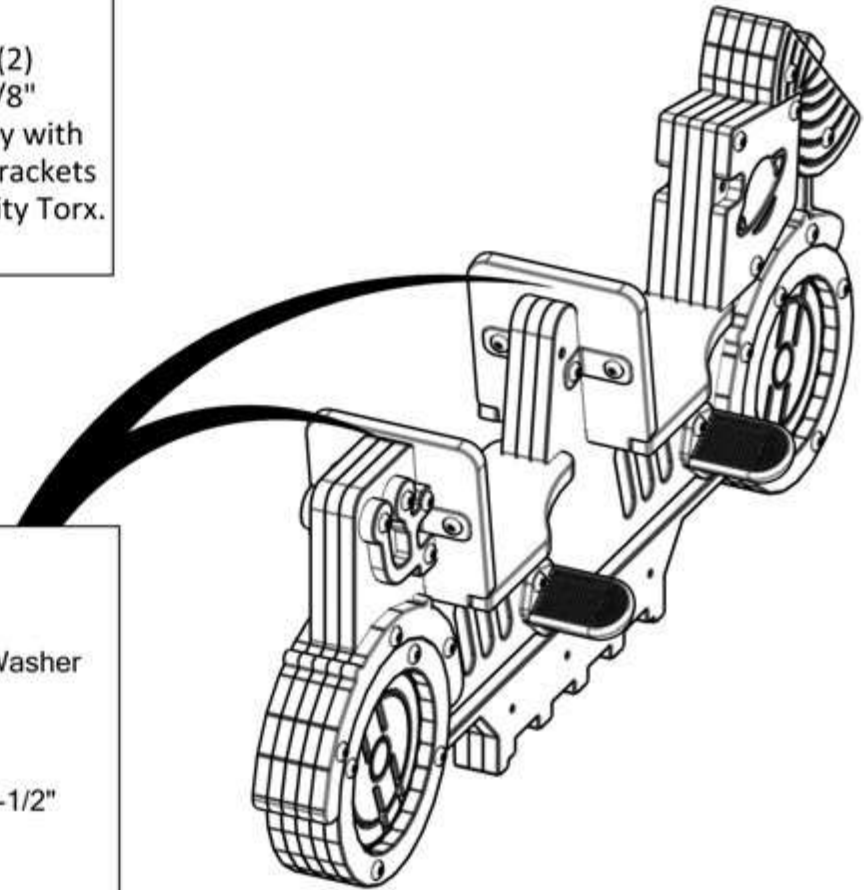
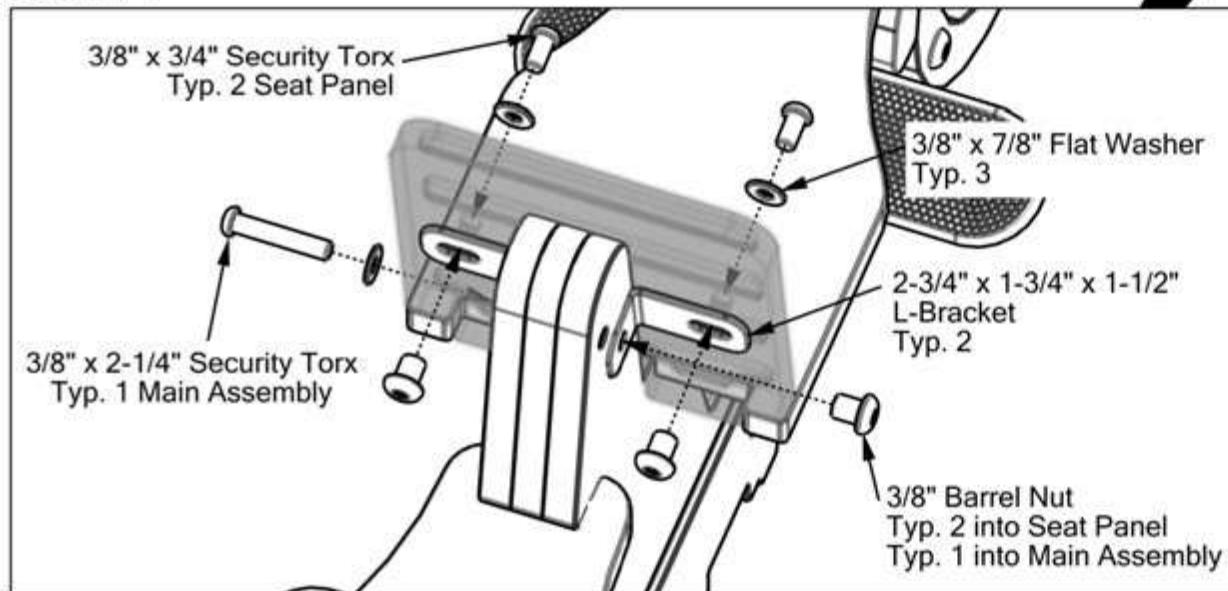

## STEP 8

Secure yoke panels to main assembly. For each yoke panel, place two (2) 2-3/4" x 1-3/4" x 1-1/2" L-brackets against back of yoke panel. Insert three (3) 3/8" barrel nuts in yoke panel and right main panel. Secure brackets to main assembly with one (1) 3/8" x 7/8" flat washer and one (1) 3/8" x 2-1/4" security Torx. Secure brackets to yoke panel with two (2) 3/8" x 7/8" flat washers and two (2) 3/8" x 3/4" security Torx. See Detail 8-1. Repeat for second yoke panel.

## Detail 8-1

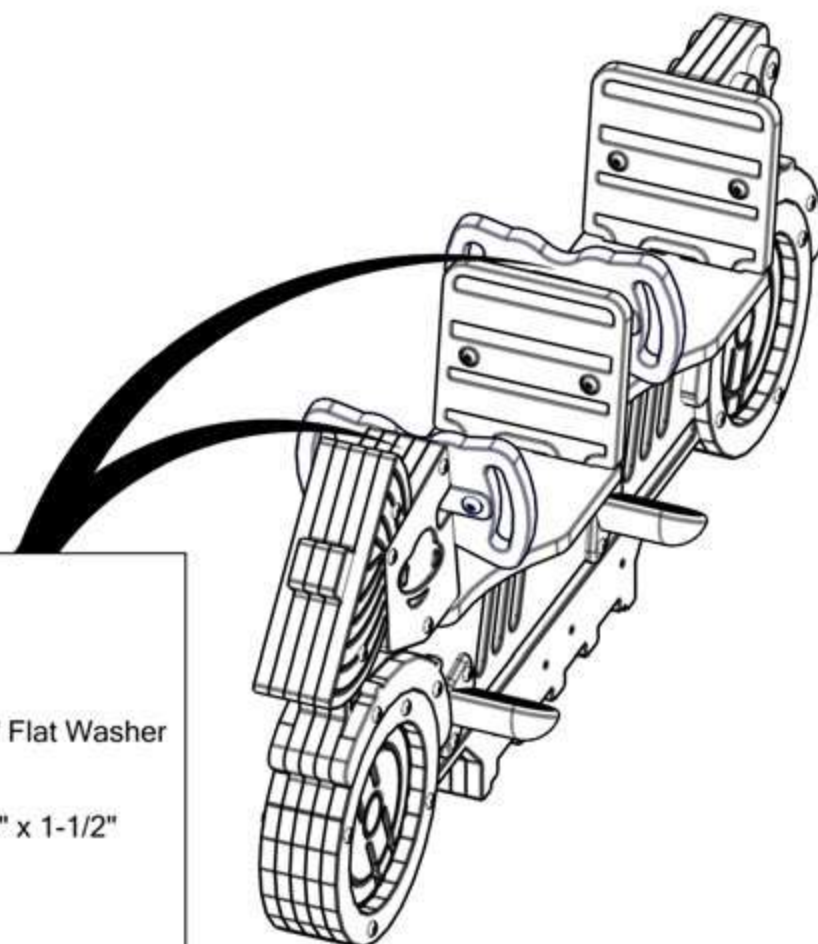
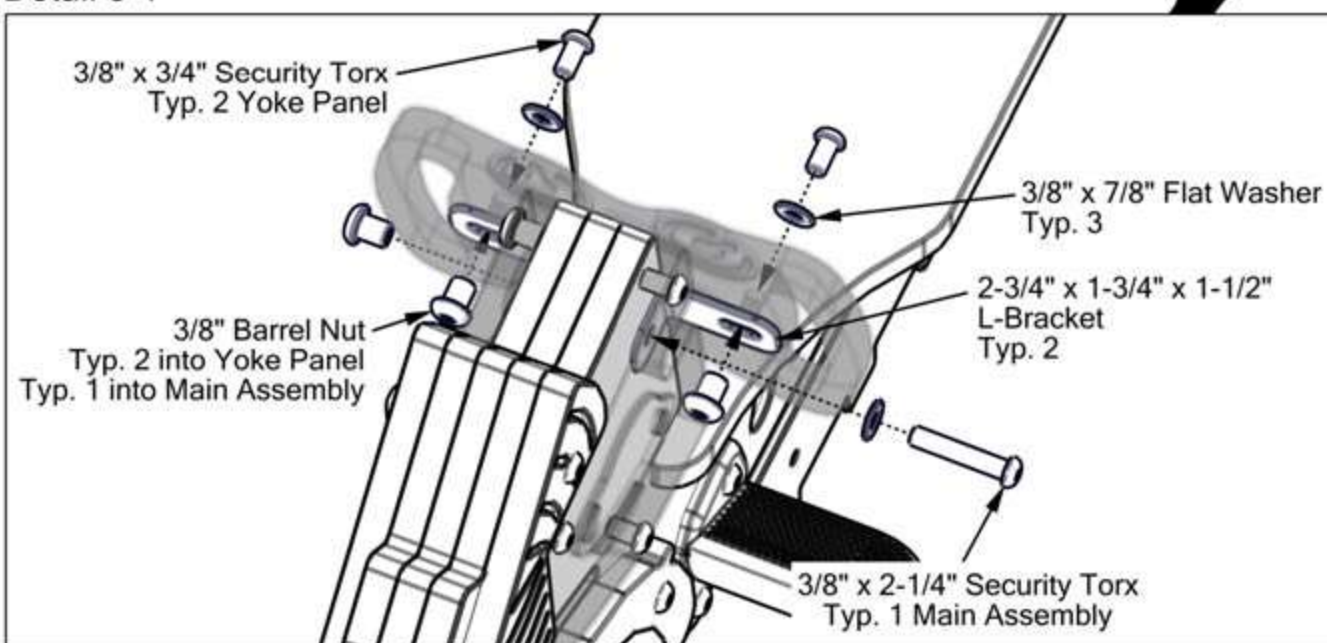



### STEP 9

Mount rider assembly to spring assemblies. Place one (1) spacer panel on each side of rider assembly tabs. Align notches in spacer panels with notches in rider assembly tabs. Place rider assembly and spacer panels into spring assembly brackets. Insert four (4) 3/8" barrel nuts into spring assembly brackets. Secure with four (4) 3/8" x 1" flat washers and four (4) 3/8" x 4" security Torx.

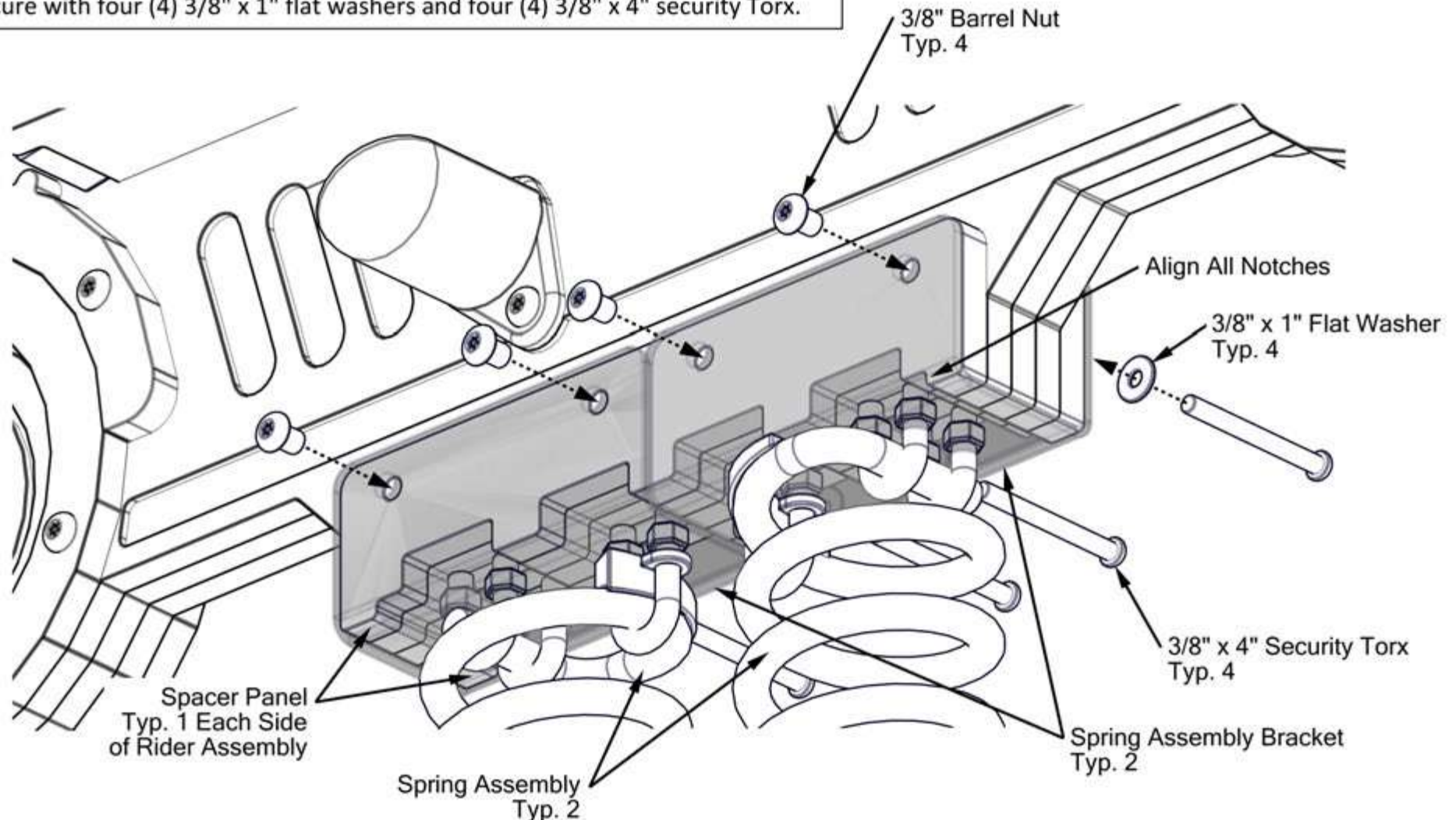

**STEP 10**

Ensure concrete is fully cured. Remove top 1/2" lock nuts and 1/2" flat washers. Remove template. Place spring rider assembly onto J-bolts. Replace 1/2" flat washers and 1/2" lock nuts. Elevation of rider seat above finished surfacing **MUST BE 22" to 28"**. See Detail 10-1. Adjust 1/2" nuts below and above rider base plate to level rider. Check all connections and ensure structure is stable. Installation is complete. Place one (1) Age Appropriate Sticker on structure in a clearly visible location.

**Detail 10-1**