

USER GROUP: 2-5 Years

RECOMMENDED CREW: 1 Person

TOOLS REQUIRED:

- TT-45 Torx, 3/4" Hex
- Level, Square
- Auger / Post Hole Digger / Shovel
- Drill Bits: 5/8"
- High Speed 3/8" Electric Drill with Clutch
- Wood / Plastic Saw

NOTE: Use of any other driver may result in damage to tool and/or hardware!

INSTALLATION TIME: 2 Hours

WEIGHT: 60 lbs.

CONCRETE REQUIRED: (6) 80lb. bags

NOTE: Concrete must have a minimum rating of 2,500 psi and must be mixed per manufacturer's recommendations.

PRE-INSTALLATION CHECK:

Customer is responsible for verifying materials received by comparing received items with packing list. If any parts are missing or damaged, contact your local sales representative immediately.

Supplier is not responsible for items discovered missing after 72 hours from time of delivery.

Before beginning installation, all installers must read and understand the Installation Introduction manual as supplied. If you did not receive a copy, or if you have any questions regarding any information in the Installation Instructions or this Installation Guideline, contact your local sales representative.

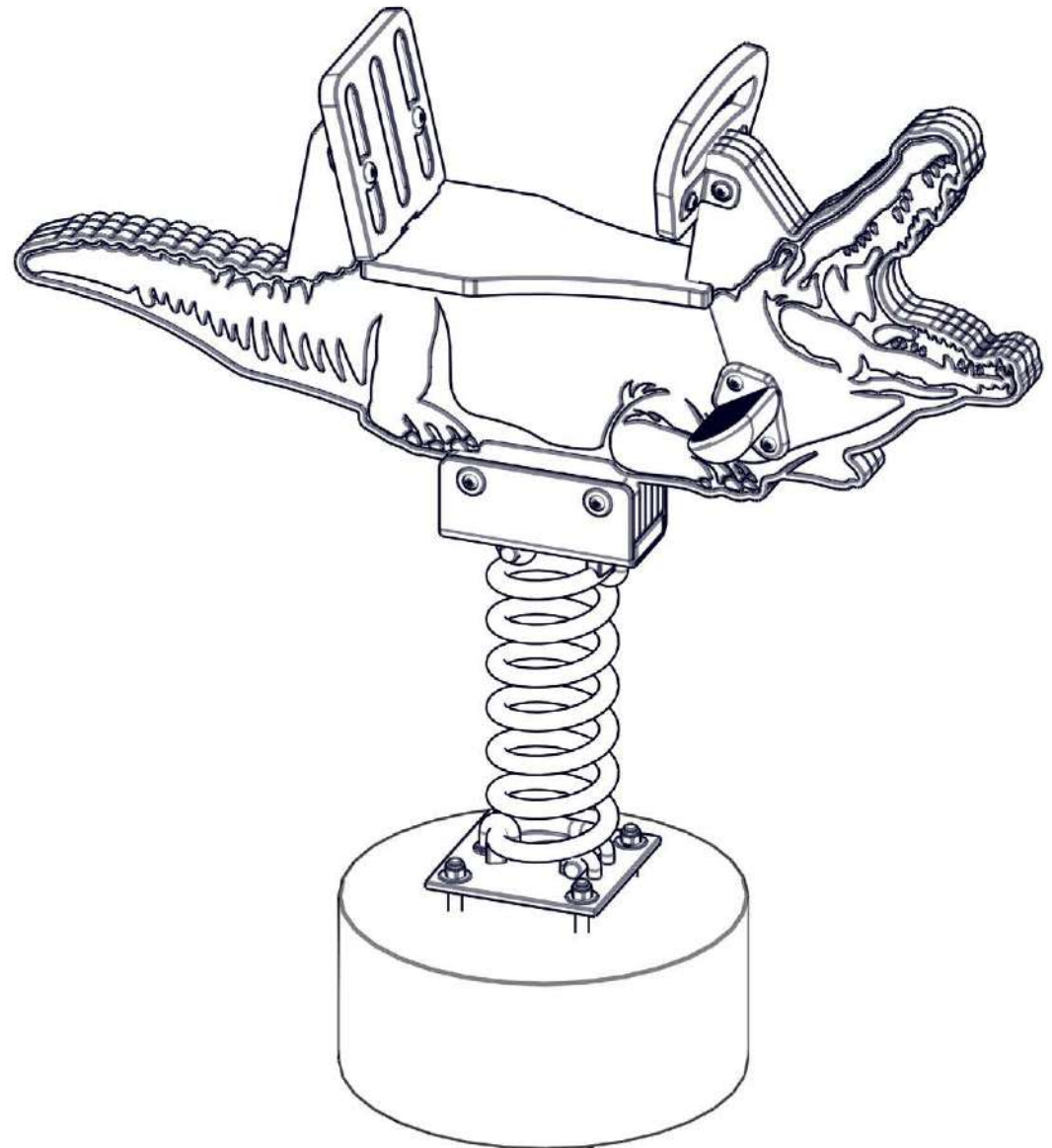

Spring Rider - 1 Seat - Alligator • Model TFR0510XX

INSTALLATION GUIDELINE

ITEM	Part No.	QTY	DESCRIPTION
1	RSP-4151XX	1	Sheet - Alligator Spring Rider Slide - Left
2	RSP-4153XX	1	Sheet - Alligator Spring Rider Center
3	RSP-4154XX	1	Sheet - Alligator Spring Rider Slide - Right
4	RSP-4155XX	1	Sheet - Gator Spring Rider Seat
5	RSP-4156XX	1	Sheet - Gator Spring Rider Seat Back
6	RSP-4157XX	1	Sheet - Gator Spring Rider Handle
7	RSP-1376XX	2	Sheet - Spring Rider Bracket Spacer
8	RSP09951XX	1	Routed U-Bracket Nut Spacer
9	30218101XX	2	Foot Peg - Aluminum W/Two Mounting Holes (Coated)
10	MTA39809XX	1	Coil Spring U-Brkt Asm.
11	HWA0009	4	Anchor 1/2 x 12-1/2 SS J-Bolt
12	HWWR0022	4	Washer 1/2" ID Flat USS 316 SS
13	HWN0025	4	Nut - 1/2"-13 Nylock 316 SS
14	30318103XX	4	Bracket-L-2 3/4" X 1 3/4" X 1 1/2" (Coated)
15	HWB0315	4	Bolt - 3/8" x 3/4" Security Torx With Patch
16	HWB0305	2	Bolt - 3/8" x 2-1/4" Security Torx With Patch
17	HWB0240	2	Bolt - 3/8" x 3" Security Torx With Patch
18	HWB0513	2	Bolt - 3/8" x 4" Security Torx With Patch
19	HWWR0165	6	Washer 3/8" ID x 7/8" OD General Purpose SS
20	HWWR0092	2	Washer 3/8" ID x 1-1/4" OD Flat SS
21	HWN0128	10	3/8" -16 Barrel Nut Torx Pin 302 Stainless

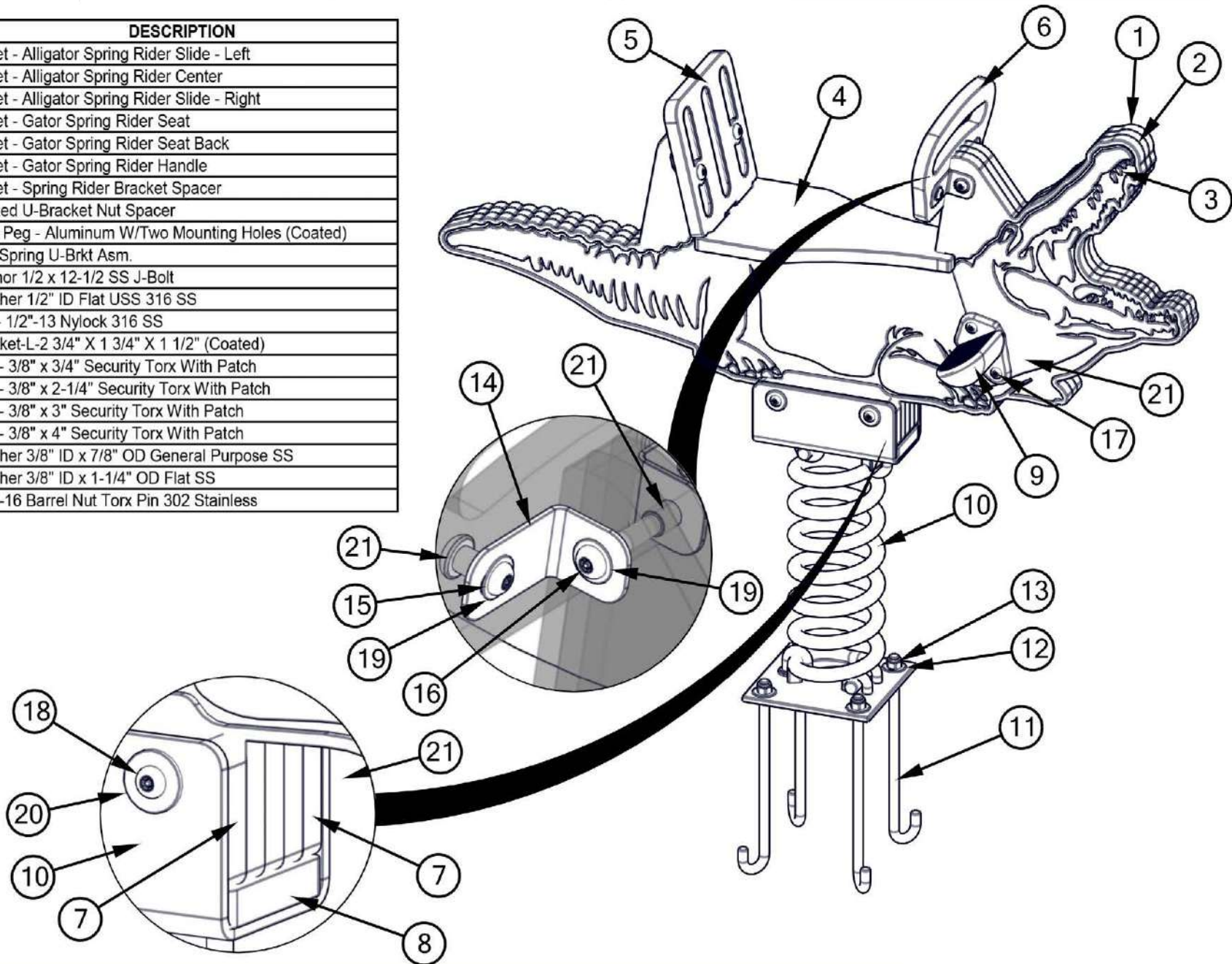

STEP 1

Use scrap poly sheet, plywood, etc. (not included) to create anchor bolt template. Cut a square piece of material to a minimum of 20" x 20". Center template on spring base plate. At each hole in spring base plate, drill one (1) 5/8" hole through template.

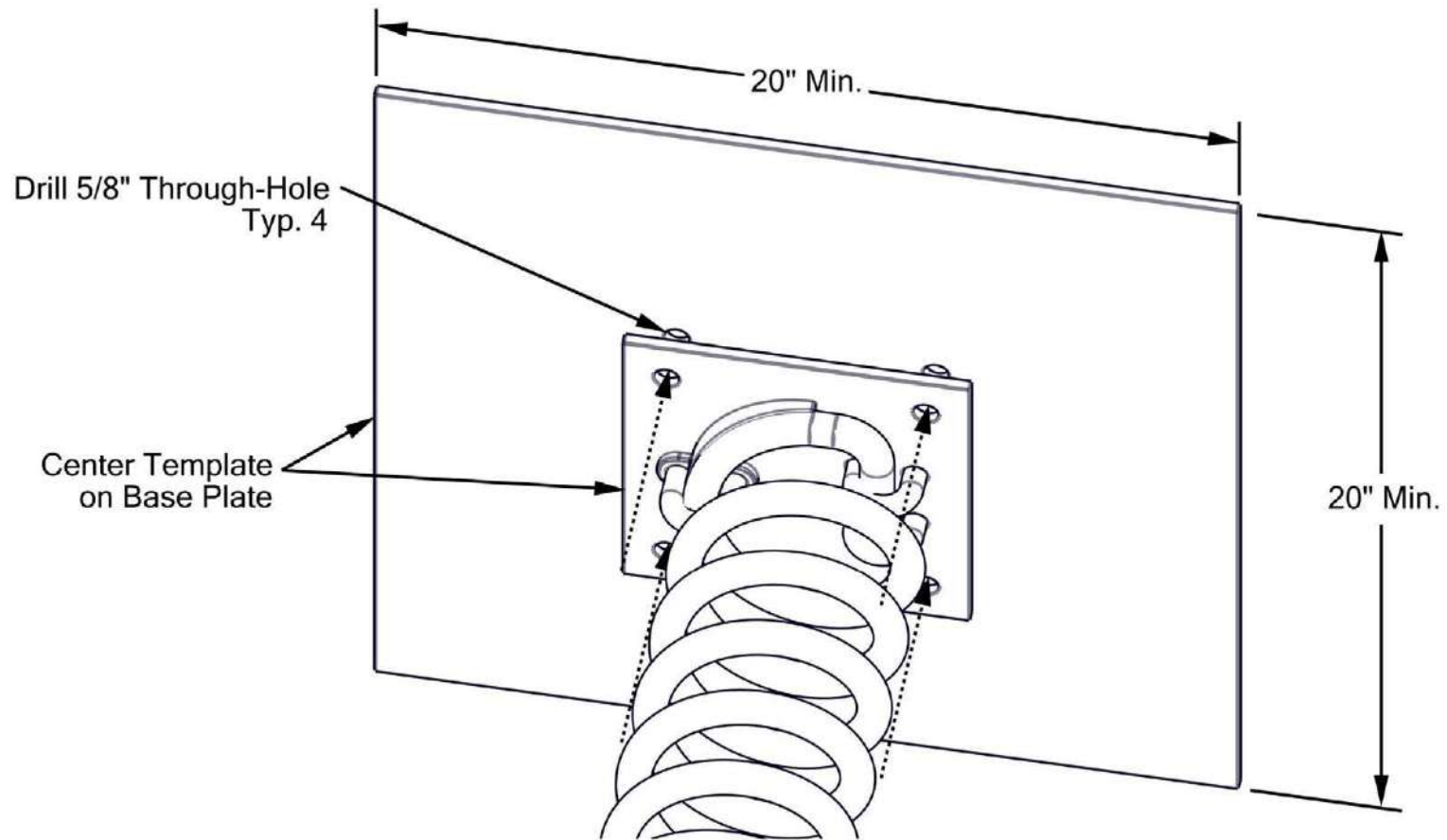

STEP 2

Mount J-bolts to template. For each J-bolt, mount one (1) 1/2" hex nut and one (1) 1/2" flat washer. Ensure all nuts and washers are same distance from bottom of nut to end of J-bolt. See Detail 2-1. Place each J-bolt through holes in template. Hook of J-bolts should point to corners of template. Secure each J-bolt with one (1) 1/2" flat washer and one (1) 1/2" Nylon lock nut.

Detail 2-1

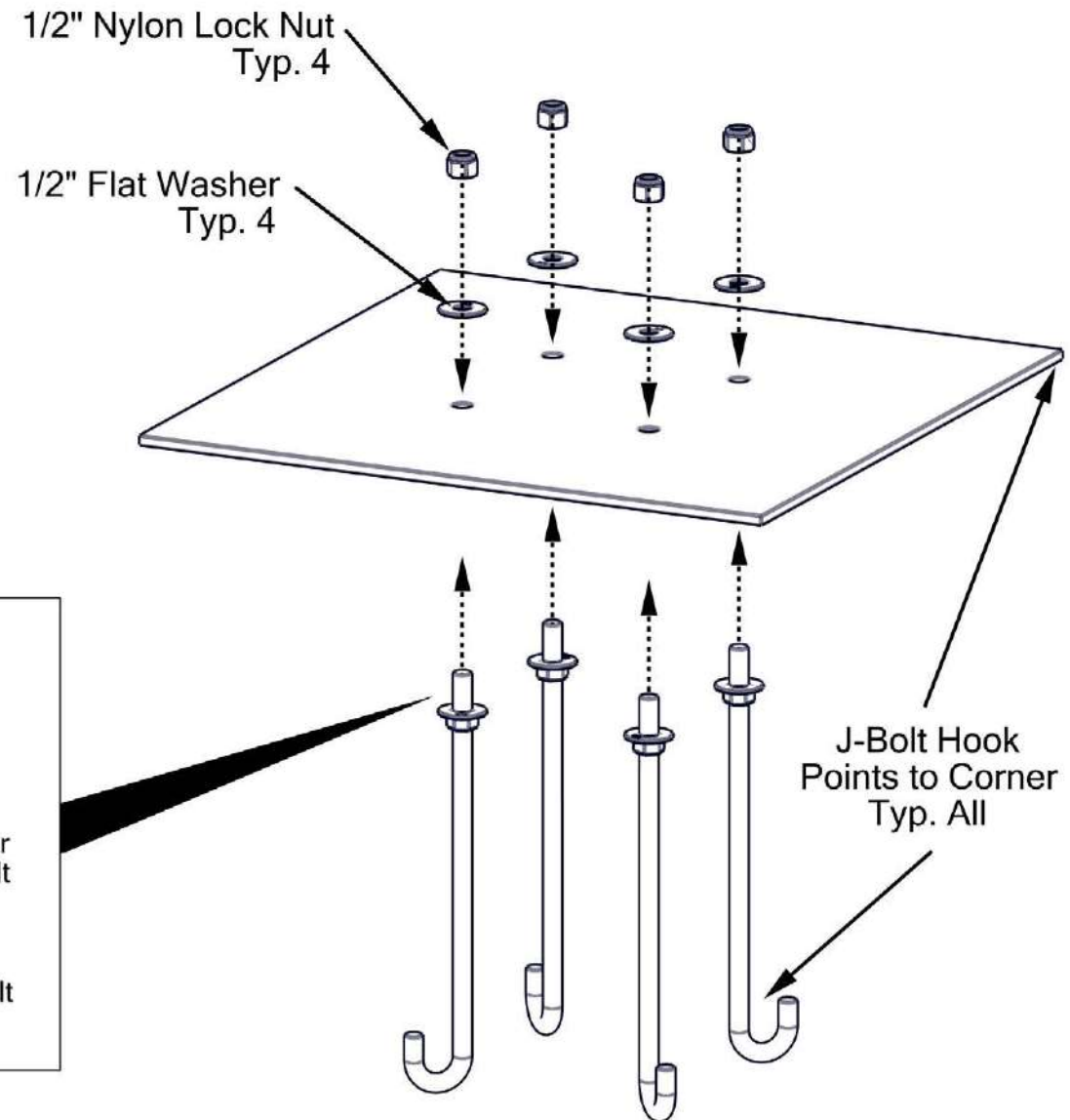
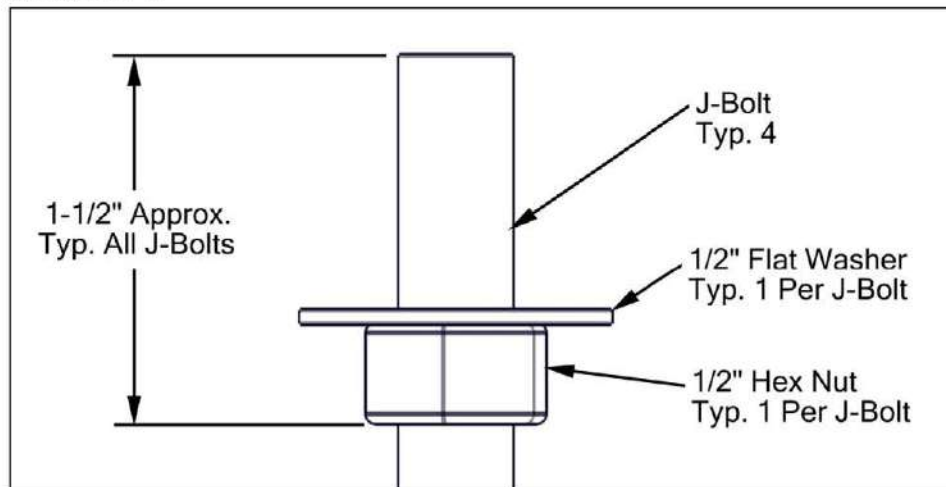

STEP 3

Prepare footing hole and set J-bolts. Concrete footing for J-bolts must be 18" diameter and 24" tall with 8" of concrete ABOVE GRADE and 16" of concrete BELOW GRADE. Position template 1-1/2" above top of concrete level so hex nuts can be adjusted. Hex nuts will be used to level spring rider. Center J-bolts on footing hole. Ensure template is level. Ensure template is fully supported. Fill footing hole and form to proper level. Bevel top edge of concrete to eliminate sharp corner. Allow concrete to fully cure based upon manufacturer's instructions before mounting spring rider.

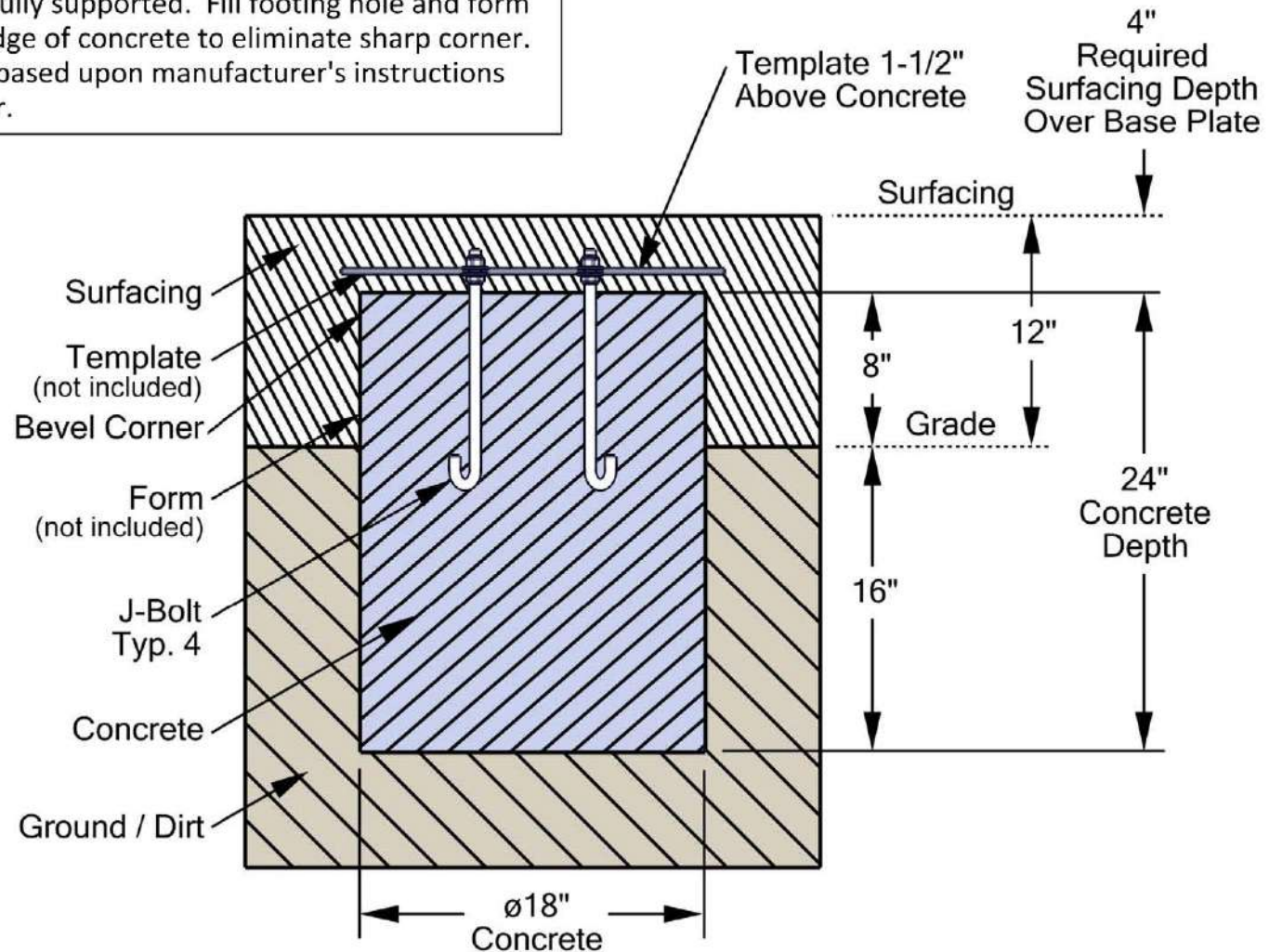

STEP 4

Assemble main panels and foot pegs. Align holes in foot pegs with holes through all three (3) main panels. Design side of outside panels face outward. Insert two (2) 3/8" barrel nuts into right foot peg. Secure through all three (3) main panels and through left foot peg with two (2) 3/8" x 3" security Torx. Ensure all edges of main panels are aligned and fully tighten hardware.

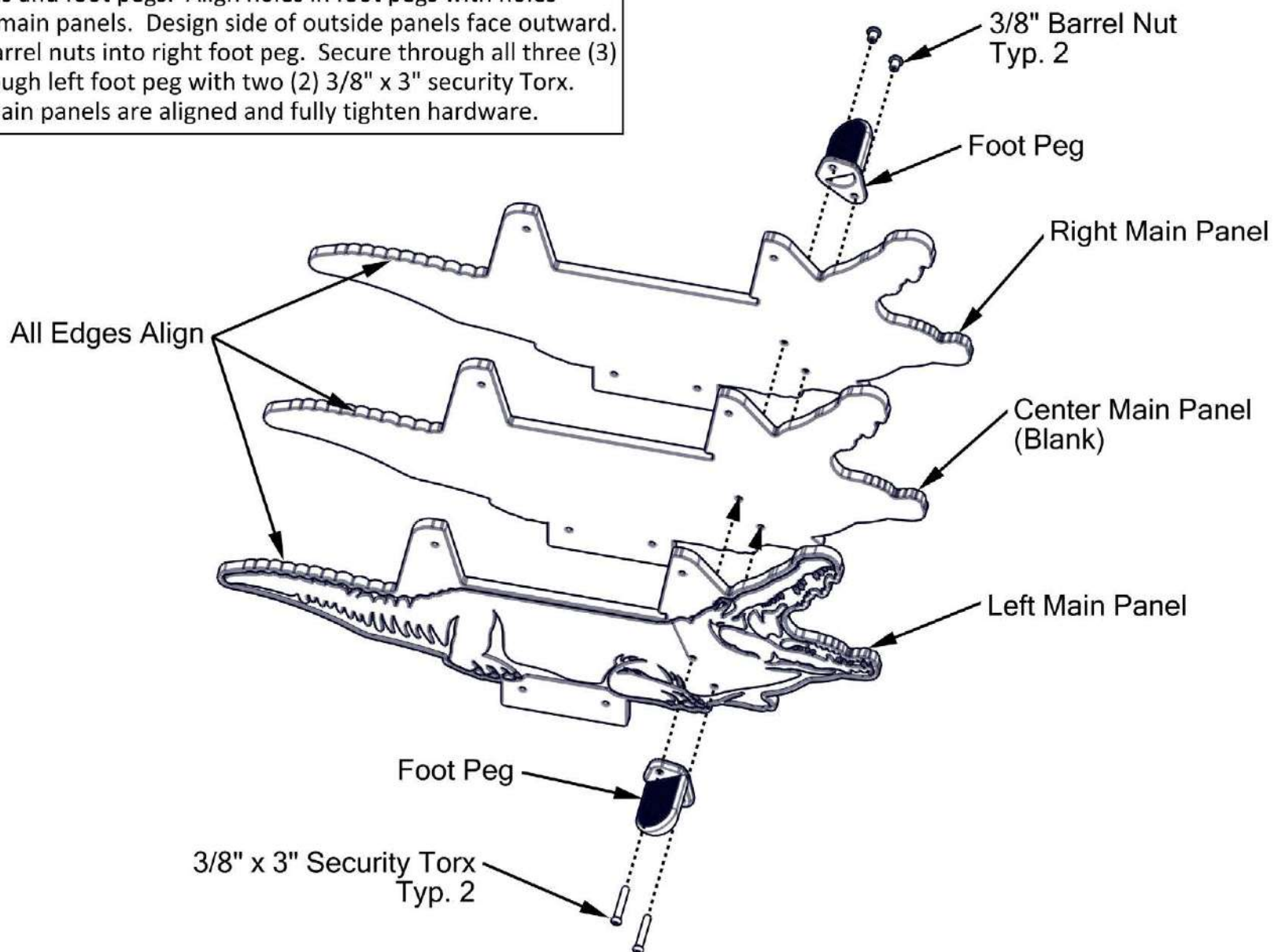

STEP 5

Place seat panel onto main panels. Ensure front notch in seat panel fits around sides of main panels. Place back panel tabs into notches in rear of seat panel.

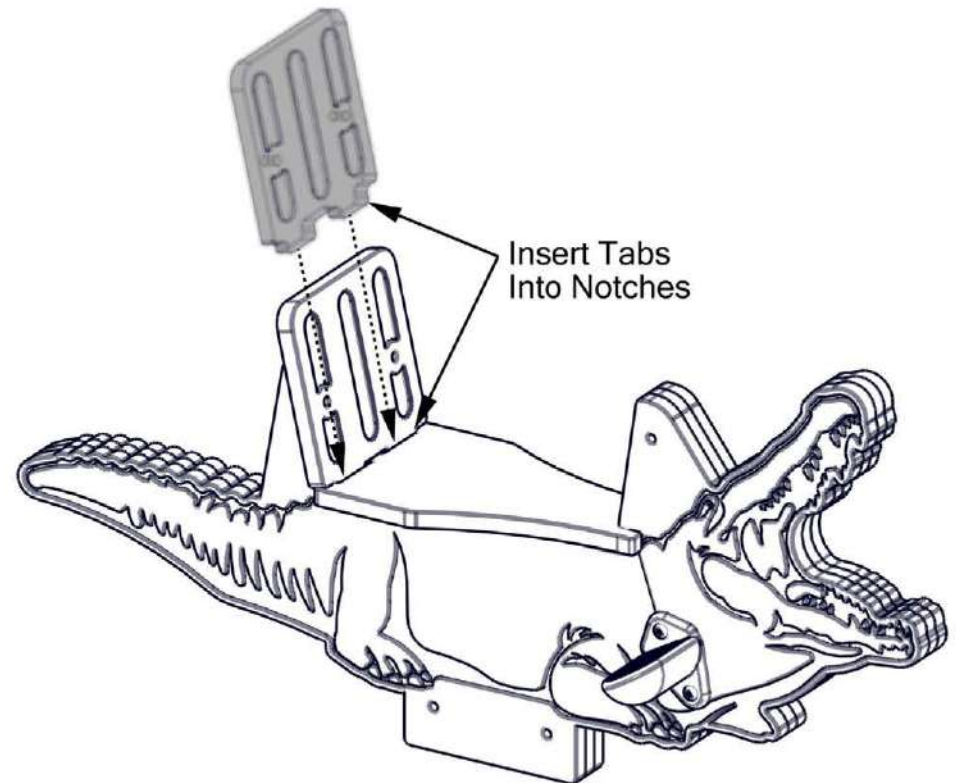
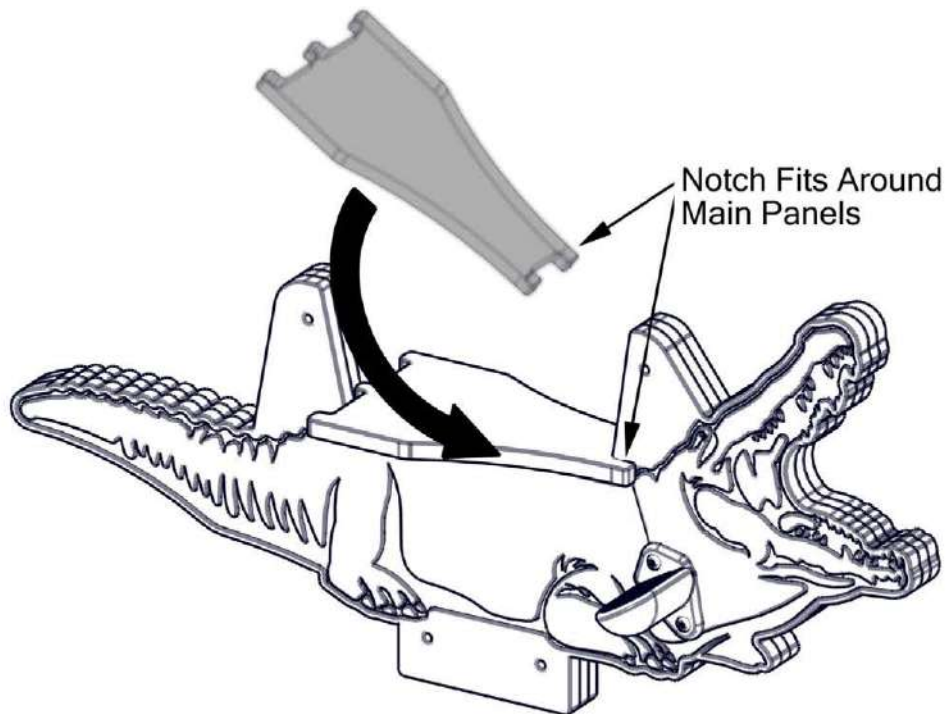

STEP 6

Secure back panel to main panels. Place two (2) L-brackets on each side of main panels. Long leg of L-brackets should be against back panel. Secure L-brackets to main panels with one (1) 3/8" barrel nut, one (1) 3/8" x 7/8" flat washer, and one (1) 3/8" x 2-1/4" security Torx. Secure L-brackets to seat back with two (2) 3/8" barrel nuts, two (2) 3/8" x 7/8" flat washers, and two (2) 3/8" x 3/4" security Torx. See Detail 6-1.

Detail 6-1

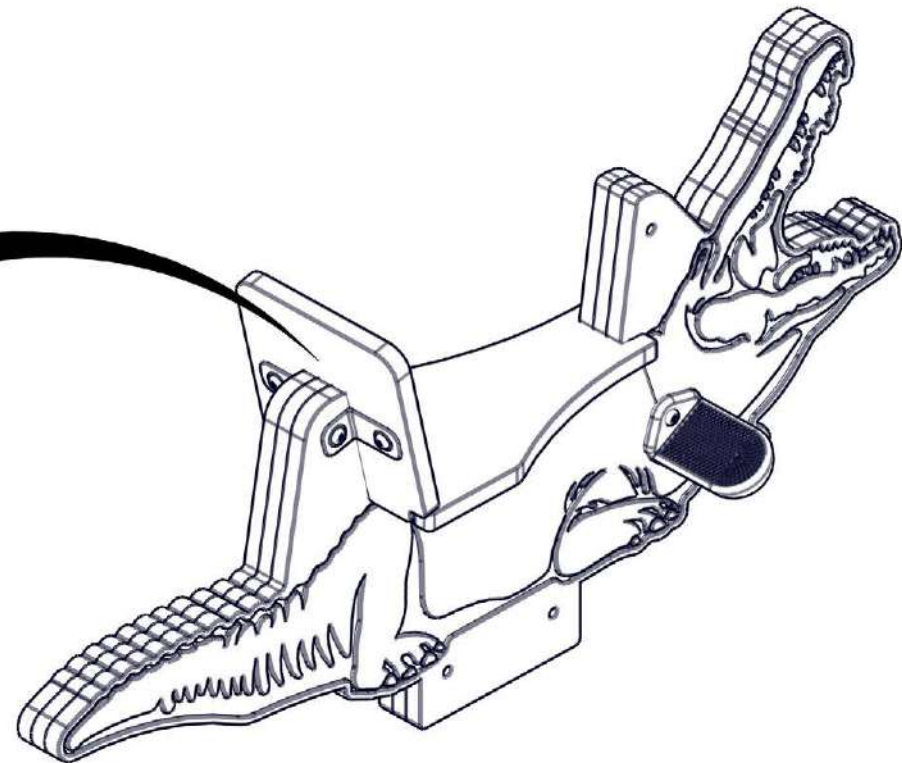
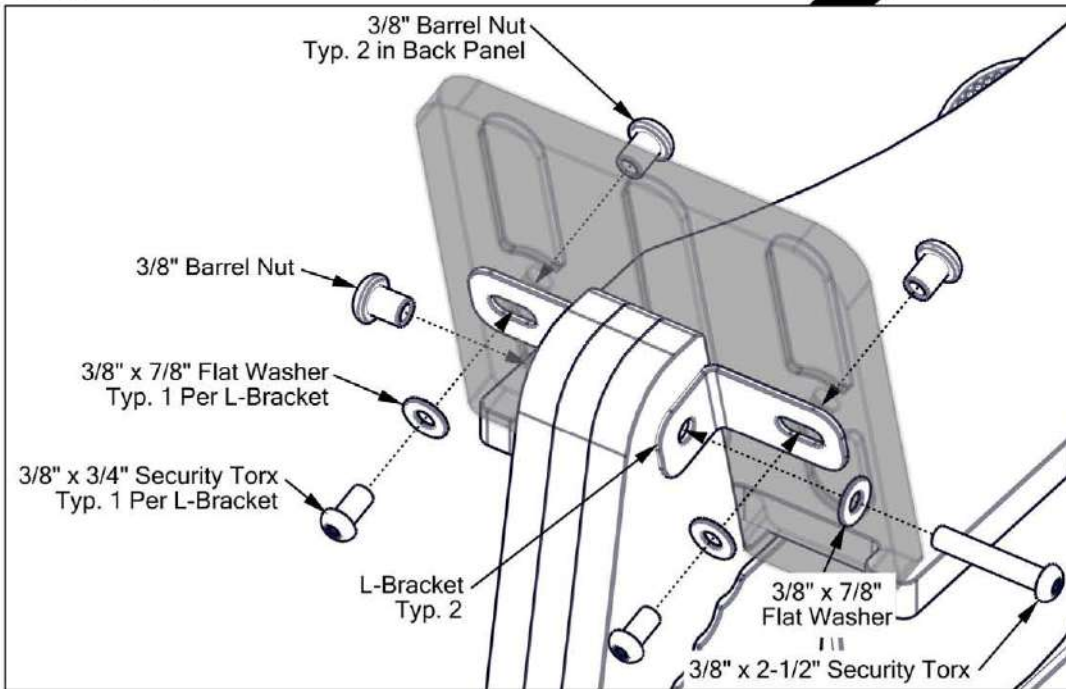

STEP 7

Secure handle panel to main panels. Place two (2) L-brackets on each side of main panels. Long leg of L-brackets should be against handle panel. Secure L-brackets to main panels with one (1) 3/8" barrel nut, one (1) 3/8" x 7/8" flat washer, and one (1) 3/8" x 2-1/4" security Torx. Secure L-brackets to handle back with two (2) 3/8" barrel nuts, two (2) 3/8" x 7/8" flat washers, and two (2) 3/8" x 3/4" security Torx. See Detail 7-1.

Detail 7-1

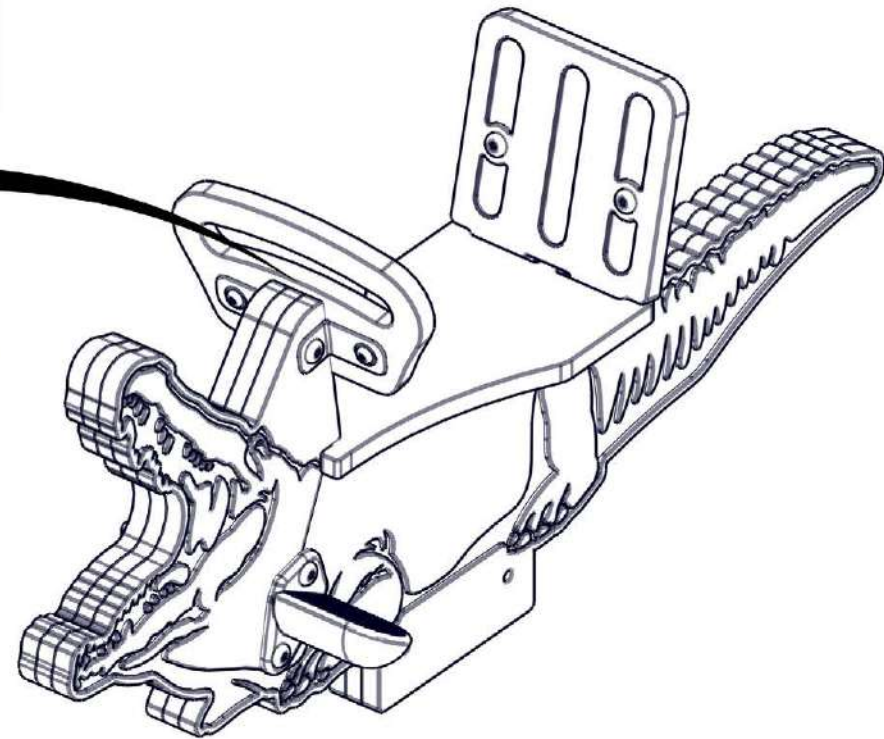
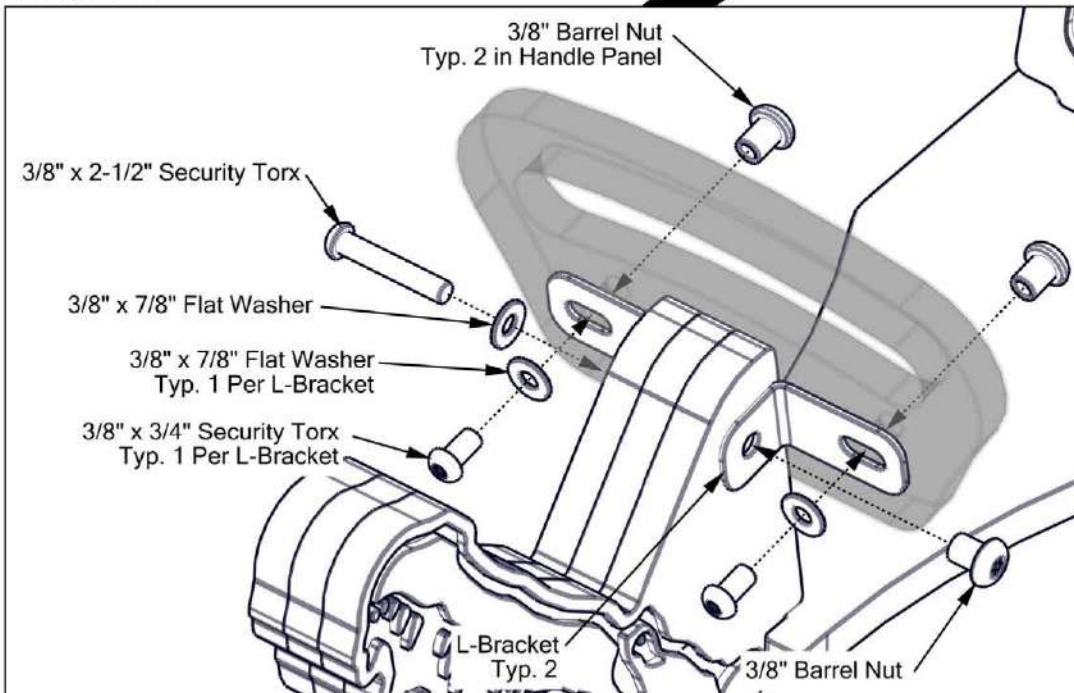

STEP 8

Mount rider assembly to spring assembly. Place 3-11/16" x 9-1/8" nut spacer panel into spring assembly bracket. Smaller opening in nut spacer panel faces up. Place one (1) 3" x 9" bracket spacer panel on each side of rider assembly tab. Insert bracket spacers and rider assembly into spring assembly bracket. Align all holes through spring assembly bracket. Secure with two (2) 3/8" barrel nuts, two (2) 3/8" x 1-1/4" flat washers, and two (2) 3/8" x 4" security Torx.

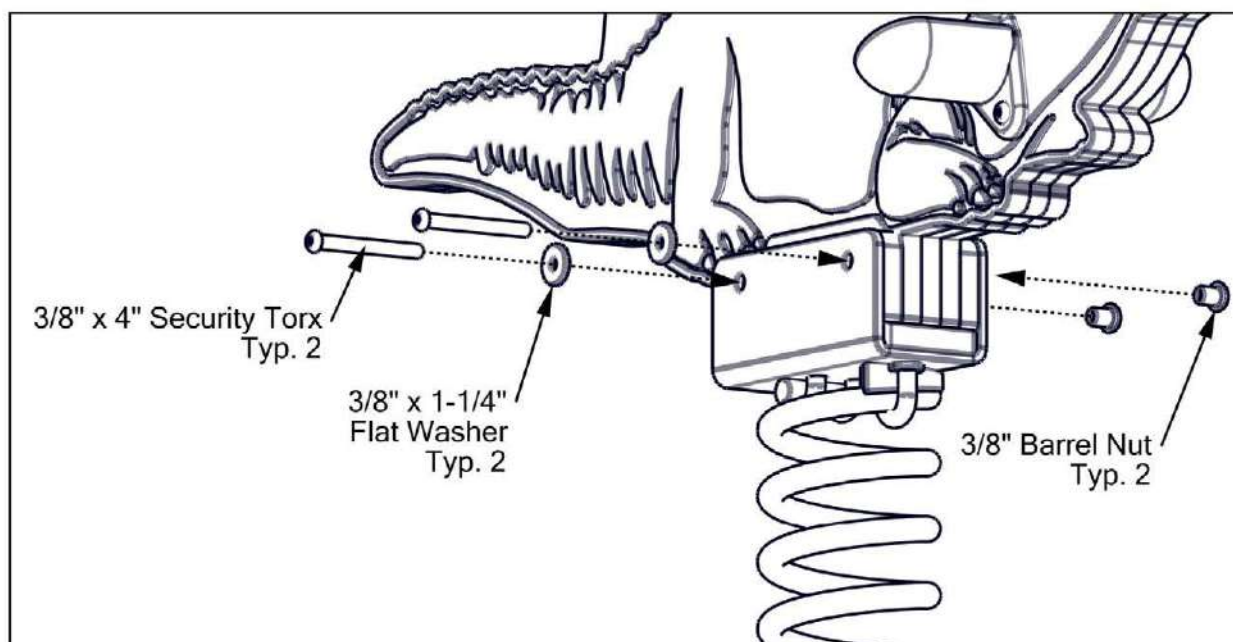
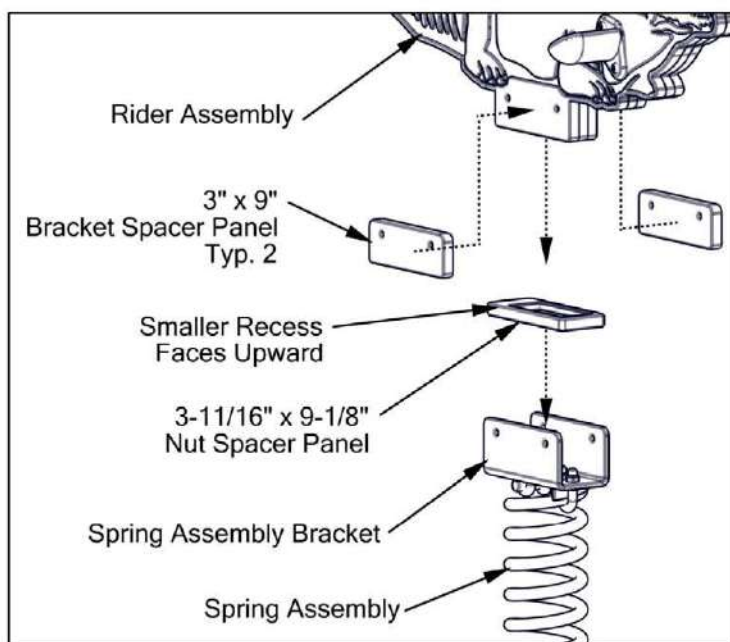

STEP 9

Ensure concrete is fully cured. Remove top 1/2" lock nuts and 1/2" flat washers. Remove template. Place spring rider assembly onto J-bolts. Replace 1/2" flat washers and 1/2" lock nuts. Elevation of rider seat above finished surfacing **MUST BE 14" to 28"**. See Detail 9-1. Adjust 1/2" nuts below and above rider base plate to level rider. Check all connections and ensure structure is stable. Installation is complete. Place one (1) Age Appropriate Sticker on structure in a clearly visible location.

Detail 9-1

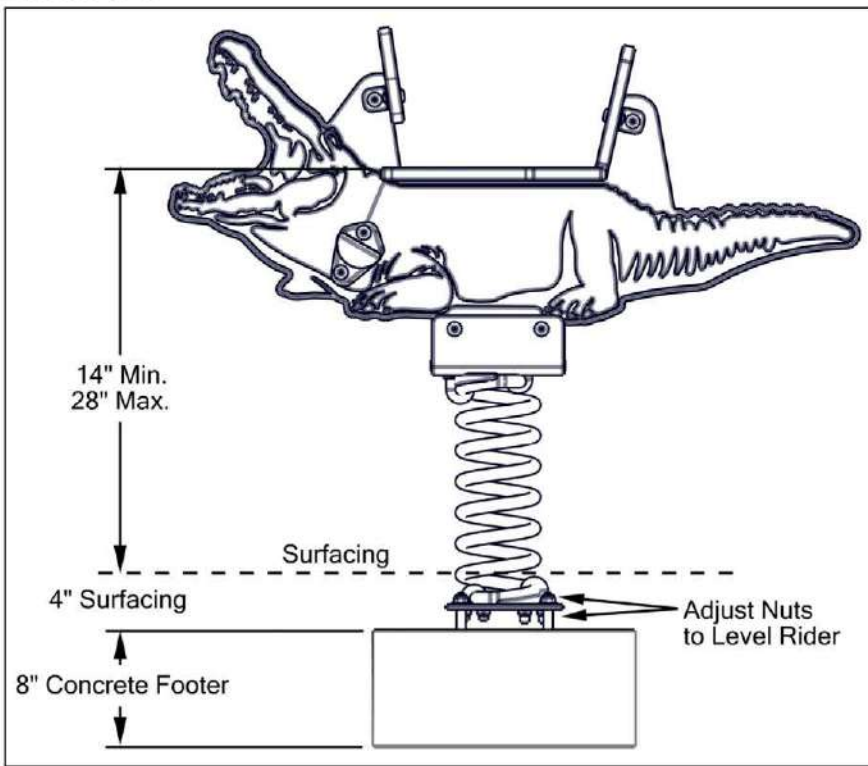

Remove Hardware
Remove Template
Place Spring Rider
Replace Hardware

Adjust 1/2" Nuts
to Level Rider

